

FREEPOINT (FP)
MODULES

FREE POINT

48V NEO-TRACK+ MONOPOINT

EDISON PRICE LIGHTING
LOS ANGELES | NEW YORK

All rights reserved. © Edison Price Lighting 2023
Due to continuous product improvements, specifications and dimensions are subject to change without notice.
Consult www.epl.com for most current technical information.

LINEAR | MODULES | SPOTLIGHTS | CYLINDERS | **NEON**

TH



Ø1.18" Spotlight

FREEPOINT™ FEATURES

48V Flexible Recessed System: Offers a flexible and easy-to-integrate solution for various optical modules, enabling product re-use and low-cost light replacement.

Easy Assembly and Disassembly: Simplifies installation and maintenance with user-friendly assembly and disassembly features.

DALI-2 Compatibility: Supports advanced DALI-2 dimming protocols for enhanced lighting control.

Variety of Lighting Options: Includes single-hole spotlights, linear lights, and decorative lights, offering a wide range of lighting possibilities.

Trim-less Recessed Installation: Provides a clean, seamless look in ceiling installations.

Robust Construction: Features easy electrical connection, a strong base for light modules, and a load-bearing buckle supporting up to 10kg.

Optics Customization: Offers a choice of 23 professional optics, enabling tailored lighting solutions for different applications.

TRACK MODULE ORDERING GUIDE

F-[PG][Model]-[CCT]-[BA]-[DM][IV][IM][TP][LE][CRI]-[Lumens]-[Finish]

EX: F-SP1612-27-24-N48C05LC90-300-B

DESCRIPTION

Step into the world of FreePoint, where lighting isn't just about seeing, it's about feeling. Our 48V recessed system is more than just a collection of lights – it's a canvas for your imagination. From the sleek elegance of our spotlights to the warm glow of our decorative lights, FreePoint is designed to blend seamlessly into your life, enhancing every space with a touch of sophistication.

Crafting Light, Creating Atmosphere.

SPECIFICATIONS DATA

Installation	Ceiling
Size(s)	Ø1.18" x 2.17"
Luminous Flux (lm)	300
Efficacy	75 LM/W
Finish(es)	Black
Dimming + Control(s)	Non-Dimming; 1-10V; DALI-2; Tuya; CASAMBI
Input Voltage	DC48V
Beam Angle	24°; 36°
UGR	<10
CRI	>90
CCT	27K; 30K; 35K; 40K
Power (W)	5
Application(s)	Indoor (IP20)

Product Group (PG)	Model (Model)	CCT (CCT)	Beam Angle (BA)	Dimming (DM)	Input Voltage (IV)	Installation Method (IM)	Typical Power (TP)	Light Engine (LE)	CRI (CRI)	Luminous Flux (Lumens)
SP Spotlight	1612 Ø 1.57" Housing Aperture; Ø1.18" Recessed Spotlight	27 27K 30 30K 35 35K 40 40K	24 24° Beam Angle 36 36° Beam Angle	N Non-Dimming V 1-10V Dimming D DALI-2 T Tuya BT C CASAMBI BT	48 DV48V	C Ceiling Mount	05 5W Power	LC LEDTEEN COB	90 90+ CRI	300 300 Lumens

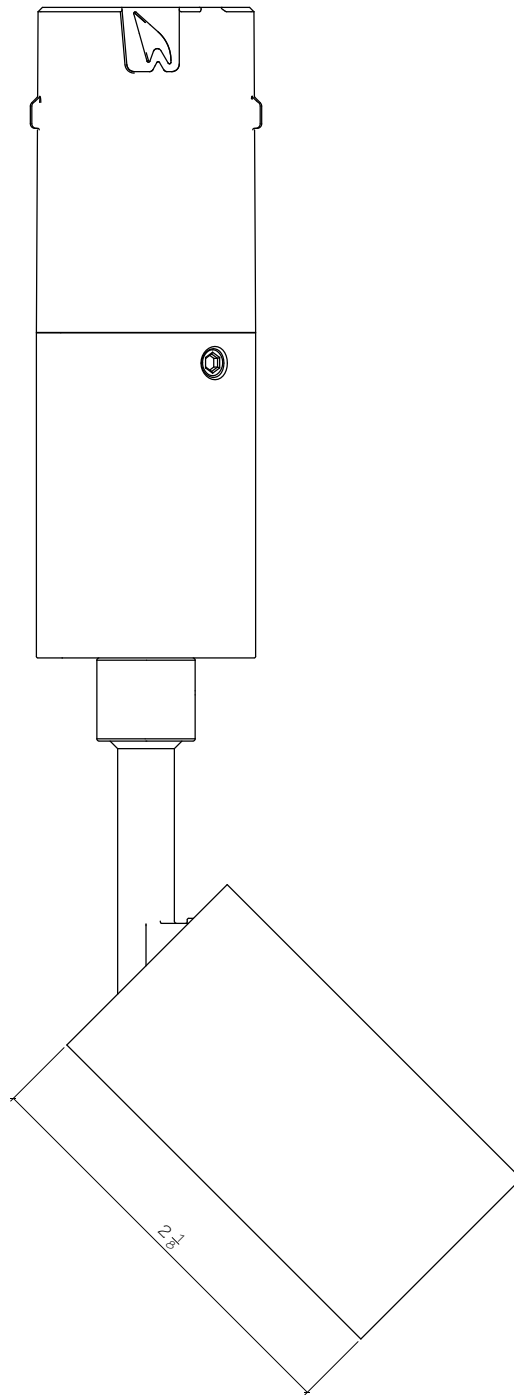
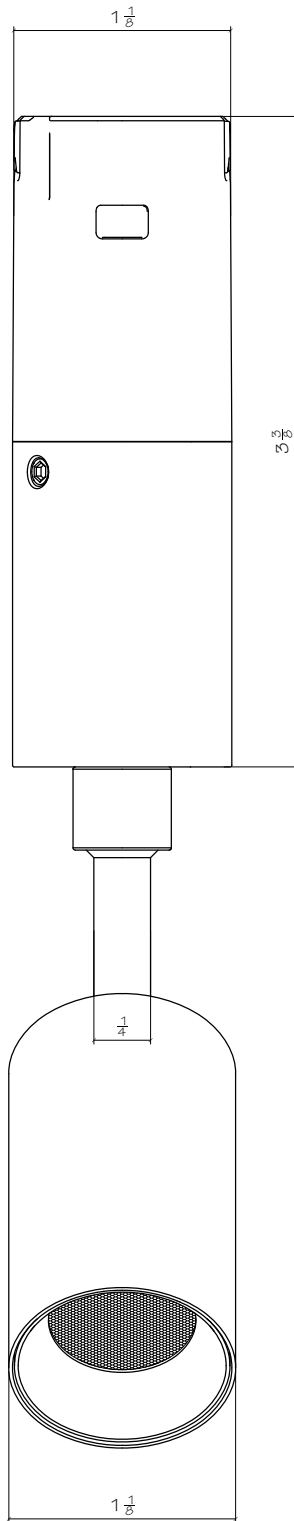



Ø1.65" Spotlight

FREEPOINT™ FEATURES

48V Flexible Recessed System: Offers a flexible and easy-to-integrate solution for various optical modules, enabling product re-use and low-cost light replacement.

Easy Assembly and Disassembly: Simplifies installation and maintenance with user-friendly assembly and disassembly features.

DALI-2 Compatibility: Supports advanced DALI-2 dimming protocols for enhanced lighting control.

Variety of Lighting Options: Includes single-hole spotlights, linear lights, and decorative lights, offering a wide range of lighting possibilities.

Trim-less Recessed Installation: Provides a clean, seamless look in ceiling installations.

Robust Construction: Features easy electrical connection, a strong base for light modules, and a load-bearing buckle supporting up to 10kg.

Optics Customization: Offers a choice of 23 professional optics, enabling tailored lighting solutions for different applications.

TRACK MODULE ORDERING GUIDE

F-[PG][Model]-[CCT]-[BA]-[DM][IV][IM][TP][LE][CRI]-[Lumens]-[Finish]

EX: F-SP1617-27-24-N48C06BC90-500-B

DESCRIPTION

Step into the world of FreePoint, where lighting isn't just about seeing, it's about feeling. Our 48V recessed system is more than just a collection of lights – it's a canvas for your imagination. From the sleek elegance of our spotlights to the warm glow of our decorative lights, FreePoint is designed to blend seamlessly into your life, enhancing every space with a touch of sophistication.

Crafting Light, Creating Atmosphere.

SPECIFICATIONS DATA

Installation	Ceiling
Size(s)	Ø1.65" x 2.68"
Luminous Flux (lm)	500
Efficacy	83 LM/W
Finish(es)	Black
Dimming + Control(s)	Non-Dimming; 1-10V; DALI-2; Tuya; CASAMBI
Input Voltage	DC48V
Beam Angle	24°; 36°
UGR	<10
CRI	>90
CCT	27K; 30K; 35K; 40K
Power (W)	6
Application(s)	Indoor (IP20)

Product Group (PG)	Model (Model)	CCT (CCT)	Beam Angle (BA)	Dimming (DM)	Input Voltage (IV)	Installation Method (IM)	Typical Power (TP)	Light Engine (LE)	CRI (CRI)	Luminous Flux (Lumens)
SP Spotlight	1617 Ø 1.57" Housing Aperture; Ø1.65" Spotlight	27 27K 30 30K 35 35K 40 40K	24 24° Beam Angle 36 36° Beam Angle	N Non-Dimming V 1-10V Dimming D DALI-2 T Tuya BT C CASAMBI BT	48 DV48V	C Ceiling Mount	06 6W Power	BC Bridgelux COB	90 90+ CRI	500 500 Lumens

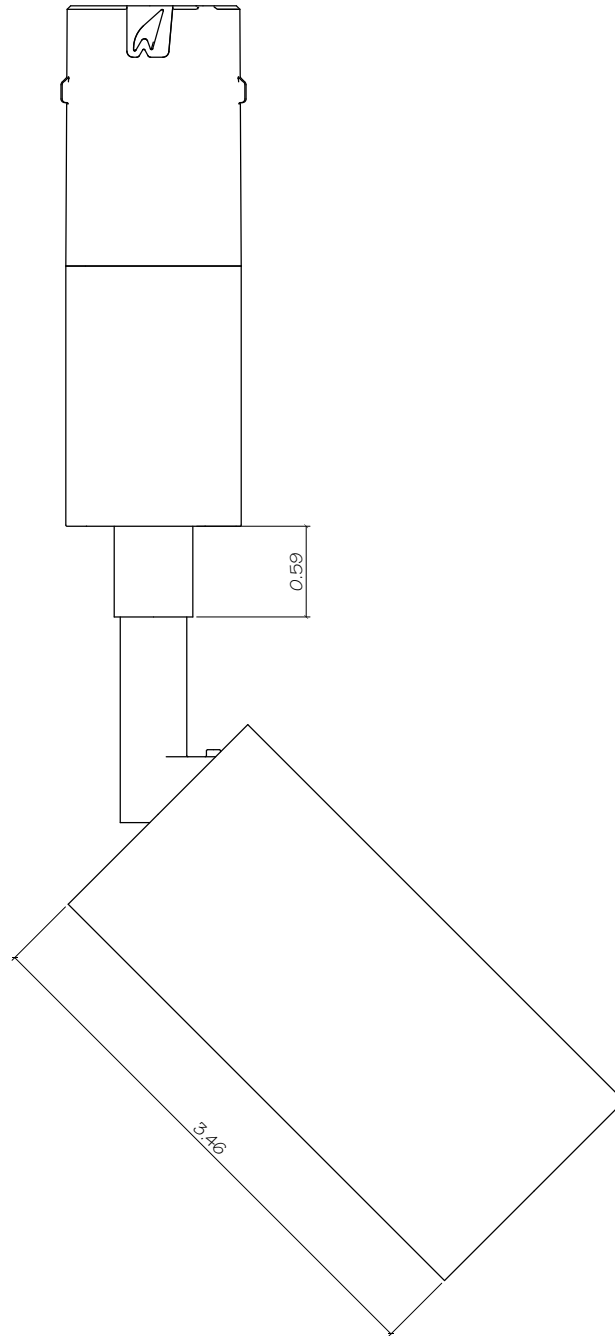
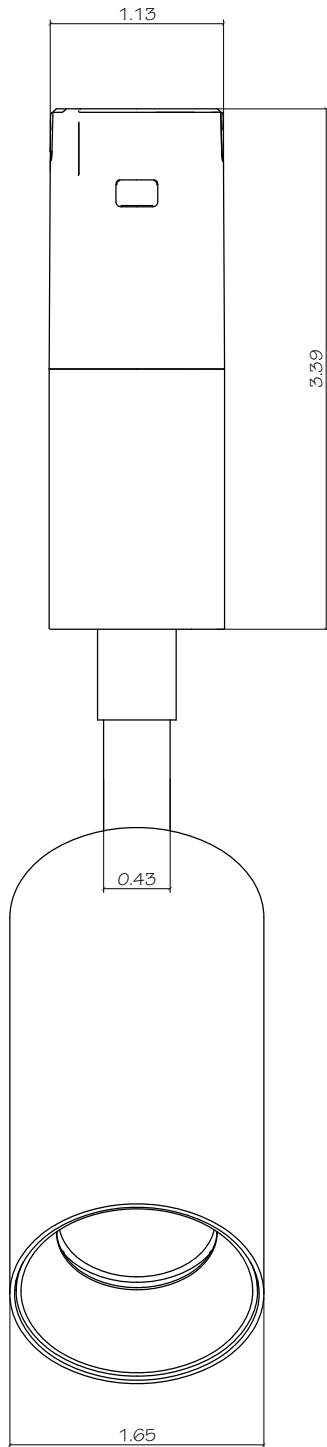



Ø2.05" Spotlight

FREEPOINT™ FEATURES

48V Flexible Recessed System: Offers a flexible and easy-to-integrate solution for various optical modules, enabling product re-use and low-cost light replacement.

Easy Assembly and Disassembly: Simplifies installation and maintenance with user-friendly assembly and disassembly features.

DALI-2 Compatibility: Supports advanced DALI-2 dimming protocols for enhanced lighting control.

Variety of Lighting Options: Includes single-hole spotlights, linear lights, and decorative lights, offering a wide range of lighting possibilities.

Trim-less Recessed Installation: Provides a clean, seamless look in ceiling installations.

Robust Construction: Features easy electrical connection, a strong base for light modules, and a load-bearing buckle supporting up to 10kg.

Optics Customization: Offers a choice of 23 professional optics, enabling tailored lighting solutions for different applications.

TRACK MODULE ORDERING GUIDE

F-[PG][Model]-[CCT]-[BA]-[DM][IV][IM][TP][LE][CRI]-[Lumens]-[Finish]

EX: F-SP1620-27-24-N48C12BC90-1020-B

DESCRIPTION

Step into the world of FreePoint, where lighting isn't just about seeing, it's about feeling. Our 48V recessed system is more than just a collection of lights – it's a canvas for your imagination. From the sleek elegance of our spotlights to the warm glow of our decorative lights, FreePoint is designed to blend seamlessly into your life, enhancing every space with a touch of sophistication.

Crafting Light, Creating Atmosphere.

SPECIFICATIONS DATA

Installation	Ceiling
Size(s)	Ø 2.05" x 3.74"
Luminous Flux (lm)	1020
Efficacy	85 LM/W
Finish(es)	Black
Dimming + Control(s)	Non-Dimming; 1-10V; DALI-2; Tuya; CASAMBI
Input Voltage	DC48V
Beam Angle	24°; 36°
UGR	<10
CRI	>90
CCT	27K; 30K; 35K; 40K
Power (W)	12
Application(s)	Indoor (IP20)

Product Group (PG)	Model (Model)	CCT (CCT)	Beam Angle (BA)	Dimming (DM)	Input Voltage (IV)	Installation Method (IM)	Typical Power (TP)	Light Engine (LE)	CRI (CRI)	Luminous Flux (Lumens)
SP Spotlight	1620 Ø 1.57" Housing Aperture; Ø2.05" Spotlight	27 27K 30 30K 35 35K 40 40K	24 24° Beam Angle 36 36° Beam Angle	N Non-Dimming V 1-10V Dimming D DALI-2 T Tuya BT C CASAMBI BT	48 DV48V	C Ceiling Mount	12 12W Power	BC Bridgelux COB	90 90+ CRI	1020 1020 Lumens

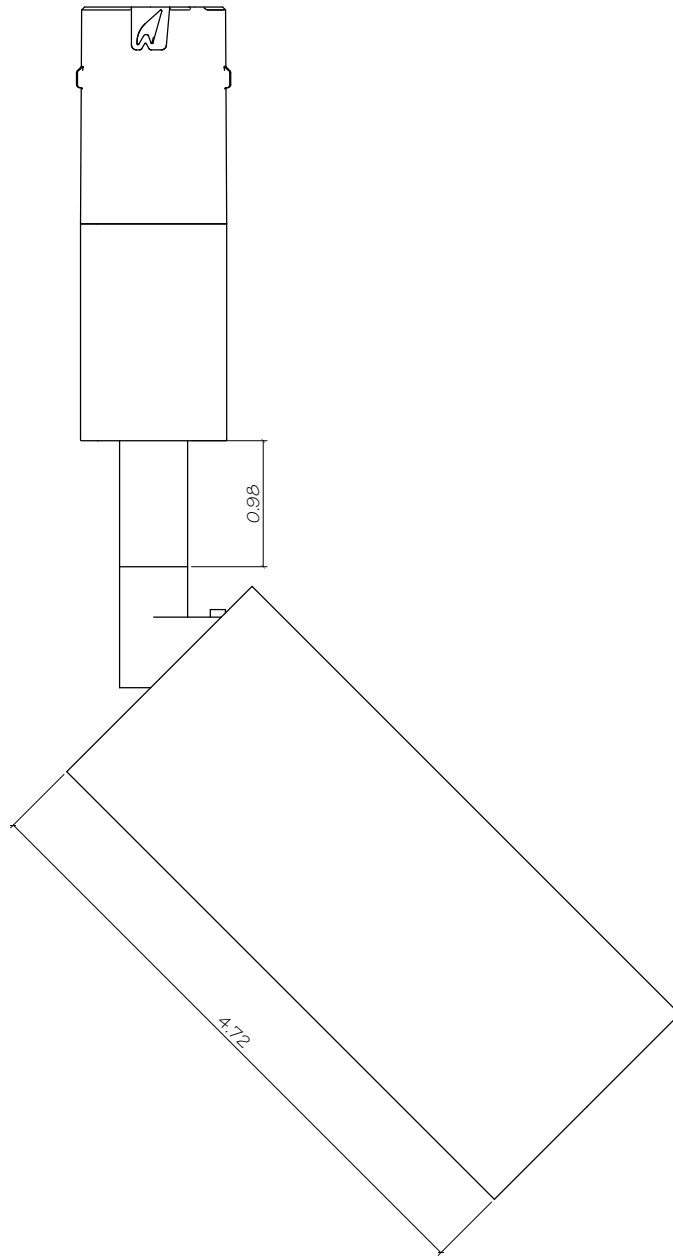
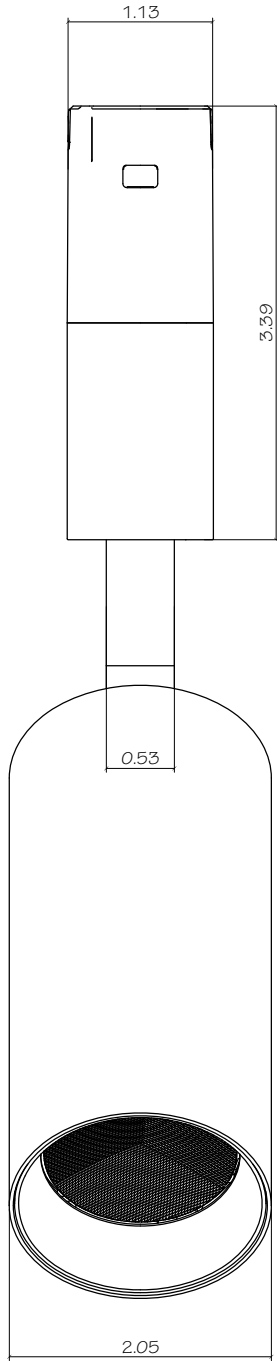



Ø2.44" Spotlight

FREEPOINT™ FEATURES

48V Flexible Recessed System: Offers a flexible and easy-to-integrate solution for various optical modules, enabling product re-use and low-cost light replacement.

Easy Assembly and Disassembly: Simplifies installation and maintenance with user-friendly assembly and disassembly features.

DALI-2 Compatibility: Supports advanced DALI-2 dimming protocols for enhanced lighting control.

Variety of Lighting Options: Includes single-hole spotlights, linear lights, and decorative lights, offering a wide range of lighting possibilities.

Trim-less Recessed Installation: Provides a clean, seamless look in ceiling installations.

Robust Construction: Features easy electrical connection, a strong base for light modules, and a load-bearing buckle supporting up to 10kg.

Optics Customization: Offers a choice of 23 professional optics, enabling tailored lighting solutions for different applications.

TRACK MODULE ORDERING GUIDE

F-[PG][Model]-[CCT]-[BA]-[DM][IV][IM][TP][LE][CRI]-[Lumens]-[Finish]

EX: F-SP1624-27-15-N48C18BC90-1080-B

DESCRIPTION

Step into the world of FreePoint, where lighting isn't just about seeing, it's about feeling. Our 48V recessed system is more than just a collection of lights – it's a canvas for your imagination. From the sleek elegance of our spotlights to the warm glow of our decorative lights, FreePoint is designed to blend seamlessly into your life, enhancing every space with a touch of sophistication.

Crafting Light, Creating Atmosphere.

SPECIFICATIONS DATA

Installation	Ceiling
Size(s)	Ø 2.44" x 5.71"
Luminous Flux (lm)	1080
Efficacy	60 LM/W
Finish(es)	Black
Dimming + Control(s)	Non-Dimming; 1-10V; DALI-2; Tuya; CASAMBI
Input Voltage	DC48V
Beam Angle	15°; 24°; 36°
UGR	<10
CRI	>90
CCT	27K; 30K; 35K; 40K
Power (W)	18
Application(s)	Indoor (IP20)

Product Group (PG)	Model (Model)	CCT (CCT)	Beam Angle (BA)	Dimming (DM)	Input Voltage (IV)	Installation Method (IM)	Typical Power (TP)	Light Engine (LE)	CRI (CRI)	Luminous Flux (Lumens)
SP Spotlight	1624 Ø 1.57" Housing Aperture; Ø2.44" Spotlight	27 27K 30 30K 35 35K 40 40K	15 15° Beam Angle 24 24° Beam Angle 36 36° Beam Angle	N Non-Dimming V 1-10V Dimming D DALI-2 T Tuya BT C CASAMBI BT	48 DV48V	C Ceiling Mount	18 18W Power	BC Bridgelux COB	90 90+ CRI	1080 1080 Lumens

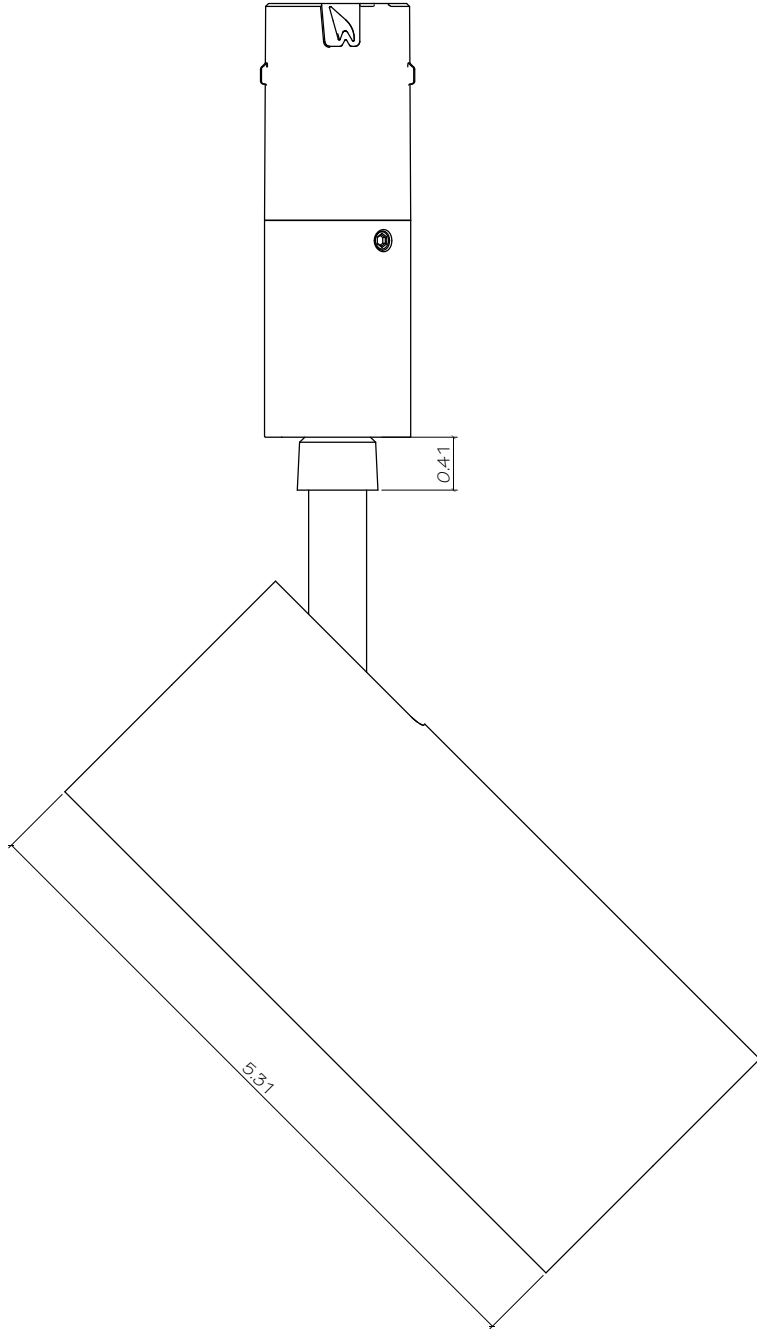
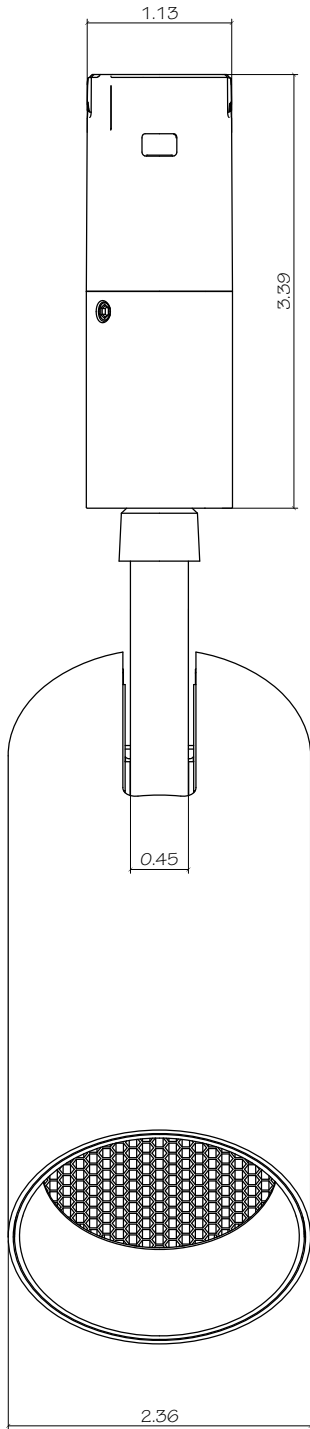



Ø1.77" Zoom Spotlight

FREEPOINT™ FEATURES

48V Flexible Recessed System: Offers a flexible and easy-to-integrate solution for various optical modules, enabling product re-use and low-cost light replacement.

Easy Assembly and Disassembly: Simplifies installation and maintenance with user-friendly assembly and disassembly features.

DALI-2 Compatibility: Supports advanced DALI-2 dimming protocols for enhanced lighting control.

Variety of Lighting Options: Includes single-hole spotlights, linear lights, and decorative lights, offering a wide range of lighting possibilities.

Trim-less Recessed Installation: Provides a clean, seamless look in ceiling installations.

Robust Construction: Features easy electrical connection, a strong base for light modules, and a load-bearing buckle supporting up to 10kg.

Optics Customization: Offers a choice of 23 professional optics, enabling tailored lighting solutions for different applications.

TRACK MODULE ORDERING GUIDE

F-[PG][Model]-[CCT]-[BA]-[DM][IV][IM][TP][LE][CRI]-[Lumens]-[Finish]

EX: F-SPZ1618-27-1250-N48C05LC90-250-B

Product Group (PG)	Model (Model)	CCT (CCT)	Beam Angle (BA)	Dimming (DM)	Input Voltage (IV)	Installation Method (IM)	Typical Power (TP)	Light Engine (LE)	CRI (CRI)	Luminous Flux (Lumens)
SPZ Zoom Spotlight	1618 Ø 1.57" Housing Aperture; Ø1.77" Zoom Spotlight	27 27K 30 30K 35 35K 40 40K	1250 12°-50° Adjustable Beam Angle	N Non-Dimming V 1-10V Dimming D DALI-2 T Tuya BT C CASAMBI BT	48 DV48V	C Ceiling Mount	05 5W Power	LC LEDTEEN COB	90 90+ CRI	250 250 Lumens

DESCRIPTION

Step into the world of FreePoint, where lighting isn't just about seeing, it's about feeling. Our 48V recessed system is more than just a collection of lights – it's a canvas for your imagination. From the sleek elegance of our spotlights to the warm glow of our decorative lights, FreePoint is designed to blend seamlessly into your life, enhancing every space with a touch of sophistication.

Crafting Light, Creating Atmosphere.

SPECIFICATIONS DATA

Installation	Ceiling
Size(s)	Ø1.77" x 3.94" L
Luminous Flux (lm)	250
Efficacy	50 LM/W
Finish(es)	Black
Dimming + Control(s)	Non-Dimming; 1-10V; DALI-2; Tuya; CASAMBI
Input Voltage	DC48V
Beam Angle	12°-50°
UGR	<10
CRI	>90
CCT	27K; 30K; 35K; 40K
Power (W)	5
Application(s)	Indoor (IP20)

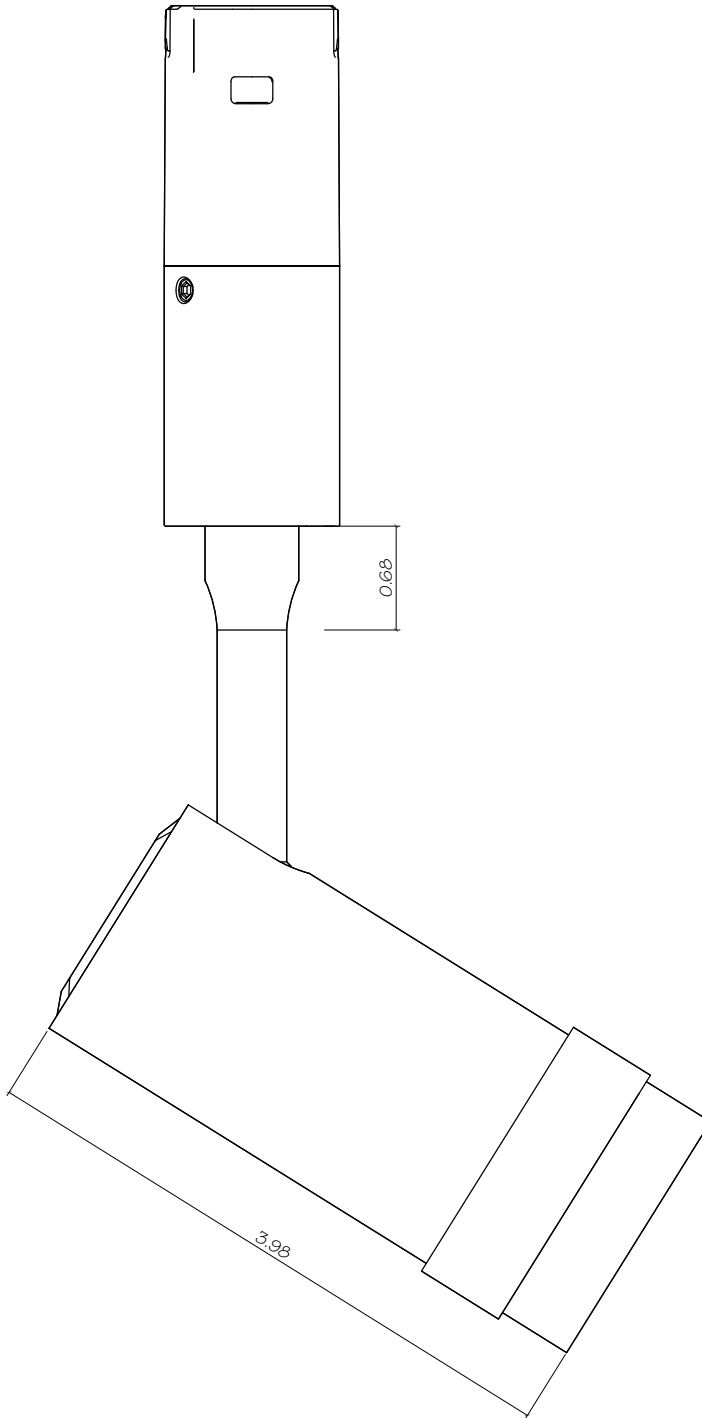
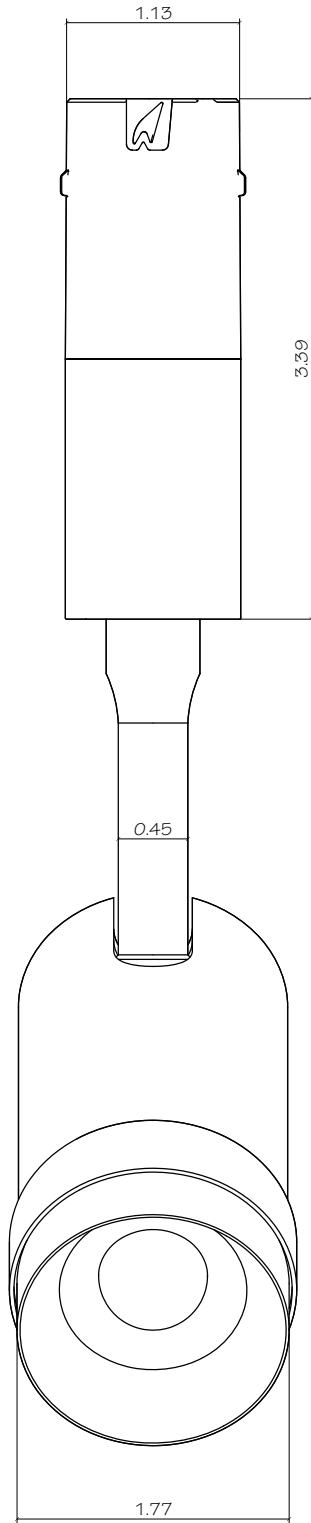



Ø2.17" Zoom Spotlight

FREEPOINT™ FEATURES

48V Flexible Recessed System: Offers a flexible and easy-to-integrate solution for various optical modules, enabling product re-use and low-cost light replacement.

Easy Assembly and Disassembly: Simplifies installation and maintenance with user-friendly assembly and disassembly features.

DALI-2 Compatibility: Supports advanced DALI-2 dimming protocols for enhanced lighting control.

Variety of Lighting Options: Includes single-hole spotlights, linear lights, and decorative lights, offering a wide range of lighting possibilities.

Trim-less Recessed Installation: Provides a clean, seamless look in ceiling installations.

Robust Construction: Features easy electrical connection, a strong base for light modules, and a load-bearing buckle supporting up to 10kg.

Optics Customization: Offers a choice of 23 professional optics, enabling tailored lighting solutions for different applications.

TRACK MODULE ORDERING GUIDE

F-[PG][Model]-[CCT]-[BA]-[DM][IV][IM][TP][LE][CRI]-[Lumens]-[Finish]

EX: F-SPZ1622-27-1540-N48C08BC90-500-B

DESCRIPTION

Step into the world of FreePoint, where lighting isn't just about seeing, it's about feeling. Our 48V recessed system is more than just a collection of lights – it's a canvas for your imagination. From the sleek elegance of our spotlights to the warm glow of our decorative lights, FreePoint is designed to blend seamlessly into your life, enhancing every space with a touch of sophistication.

Crafting Light, Creating Atmosphere.

SPECIFICATIONS DATA

Installation	Ceiling
Size(s)	Ø2.17" x 4.53" L
Luminous Flux (lm)	500
Efficacy	63 LM/W
Finish(es)	Black
Dimming + Control(s)	Non-Dimming; 1-10V; DALI-2; Tuya; CASAMBI
Input Voltage	DC48V
Beam Angle	15°-40°
UGR	<10
CRI	>90
CCT	27K; 30K; 35K; 40K
Power (W)	8
Application(s)	Indoor (IP20)

Product Group (PG)	Model (Model)	CCT (CCT)	Beam Angle (BA)	Dimming (DM)	Input Voltage (IV)	Installation Method (IM)	Typical Power (TP)	Light Engine (LE)	CRI (CRI)	Luminous Flux (Lumens)
SPZ Zoom Spotlight	1622 Ø 1.57" Housing Aperture; Ø2.17" Zoom Spotlight	27 27K 30 30K 35 35K 40 40K	1540 15°-40° Adjustable Beam Angle	N Non-Dimming V 1-10V Dimming D DALI-2 T Tuya BT C CASAMBI BT	48 DV48V	C Ceiling Mount	08 8W Power	BC Bridgelux COB	90 90+ CRI	500 500 Lumens

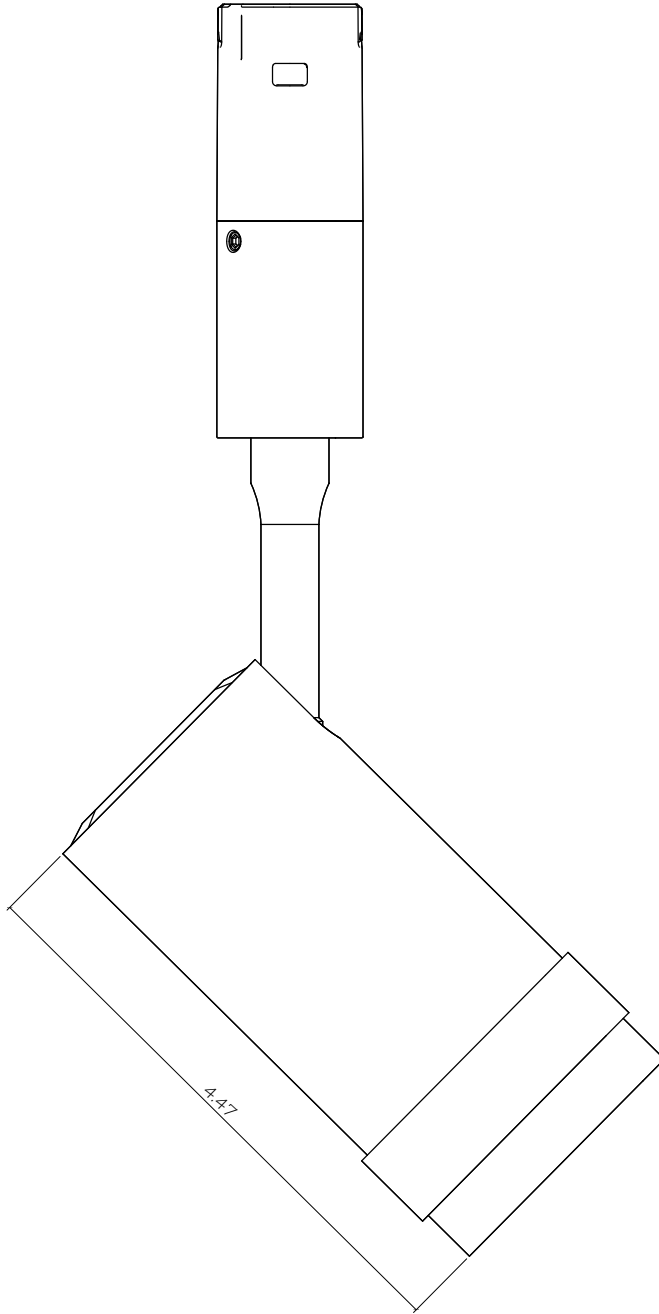
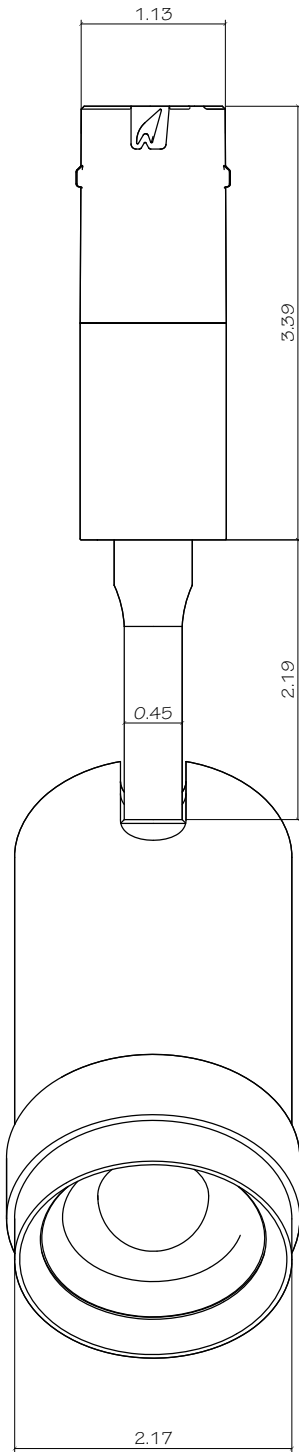



Ø2.56" Zoom Spotlight

FREEPOINT™ FEATURES

48V Flexible Recessed System: Offers a flexible and easy-to-integrate solution for various optical modules, enabling product re-use and low-cost light replacement.

Easy Assembly and Disassembly: Simplifies installation and maintenance with user-friendly assembly and disassembly features.

DALI-2 Compatibility: Supports advanced DALI-2 dimming protocols for enhanced lighting control.

Variety of Lighting Options: Includes single-hole spotlights, linear lights, and decorative lights, offering a wide range of lighting possibilities.

Trim-less Recessed Installation: Provides a clean, seamless look in ceiling installations.

Robust Construction: Features easy electrical connection, a strong base for light modules, and a load-bearing buckle supporting up to 10kg.

Optics Customization: Offers a choice of 23 professional optics, enabling tailored lighting solutions for different applications.

TRACK MODULE ORDERING GUIDE

F-[PG][Model]-[CCT]-[BA]-[DM][IV][IM][TP][LE][CRI]-[Lumens]-[Finish]

EX: F-SPZ1626-27-1536-N48C12BC90-700-B

DESCRIPTION

Step into the world of FreePoint, where lighting isn't just about seeing, it's about feeling. Our 48V recessed system is more than just a collection of lights – it's a canvas for your imagination. From the sleek elegance of our spotlights to the warm glow of our decorative lights, FreePoint is designed to blend seamlessly into your life, enhancing every space with a touch of sophistication.

Crafting Light, Creating Atmosphere.

SPECIFICATIONS DATA

Installation	Ceiling
Size(s)	Ø2.56" x 5.31" L
Luminous Flux (lm)	700
Efficacy	59 LM/W
Finish(es)	Black
Dimming + Control(s)	Non-Dimming; 1-10V; DALI-2; Tuya; CASAMBI
Input Voltage	DC48V
Beam Angle	15°-36°
UGR	<10
CRI	>90
CCT	27K; 30K; 35K; 40K
Power (W)	12
Application(s)	Indoor (IP20)

Product Group (PG)	Model (Model)	CCT (CCT)	Beam Angle (BA)	Dimming (DM)	Input Voltage (IV)	Installation Method (IM)	Typical Power (TP)	Light Engine (LE)	CRI (CRI)	Luminous Flux (Lumens)
SPZ Zoom Spotlight	1626 Ø 1.57" Housing Aperture; Ø2.56" Zoom Spotlight	27 27K 30 30K 35 35K 40 40K	1536 15°-36° Adjustable Beam Angle	N Non-Dimming V 1-10V Dimming D DALI-2 T Tuya BT C CASAMBI BT	48 DV48V	C Ceiling Mount	08 8W Power	BC Bridgelux COB	90 90+ CRI	700 700 Lumens

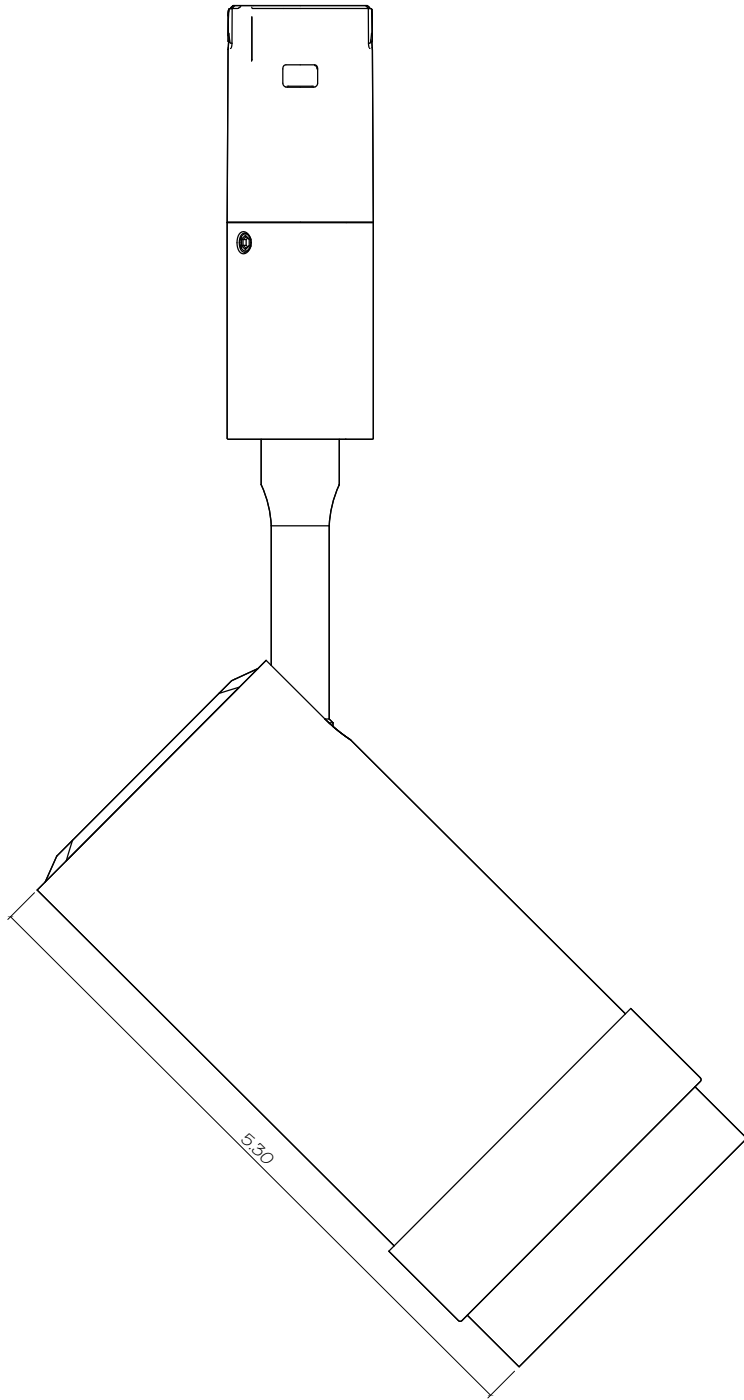
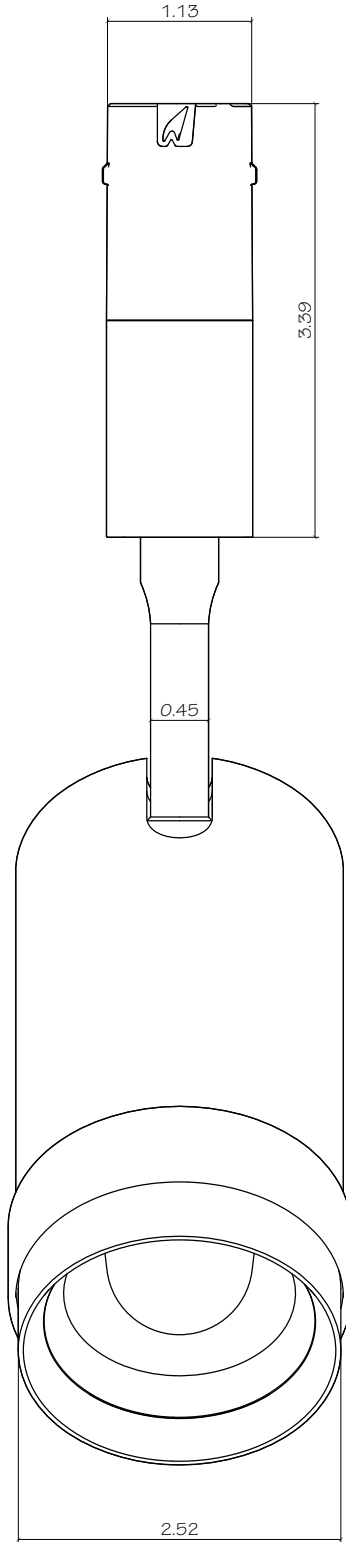



Ø1.14" Recessed Spotlight

FREEPOINT™ FEATURES

48V Flexible Recessed System: Offers a flexible and easy-to-integrate solution for various optical modules, enabling product re-use and low-cost light replacement.

Easy Assembly and Disassembly: Simplifies installation and maintenance with user-friendly assembly and disassembly features.

DALI-2 Compatibility: Supports advanced DALI-2 dimming protocols for enhanced lighting control.

Variety of Lighting Options: Includes single-hole spotlights, linear lights, and decorative lights, offering a wide range of lighting possibilities.

Trim-less Recessed Installation: Provides a clean, seamless look in ceiling installations.

Robust Construction: Features easy electrical connection, a strong base for light modules, and a load-bearing buckle supporting up to 10kg.

Optics Customization: Offers a choice of 23 professional optics, enabling tailored lighting solutions for different applications.

TRACK MODULE ORDERING GUIDE

F-[PG][Model]-[CCT]-[BA]-[DM][IV][IM][TP][LE][CRI]-[Lumens]-[Finish]

EX: F-SP1611-27-15-N48R04B390-135-B

Product Group (PG)	Model (Model)	CCT (CCT)	Beam Angle (BA)	Dimming (DM)	Input Voltage (IV)	Installation Method (IM)	Typical Power (TP)	Light Engine (LE)	CRI (CRI)	Luminous Flux (Lumens)
SP Spotlight	1611 Ø 1.57" Housing Aperture; Ø1.14" Recessed Spotlight	27 27K 30 30K 35 35K 40 40K	15 15° Beam Angle 25 25° Beam Angle	N Non-Dimming V 1-10V Dimming D DALI-2 T Tuya BT C CASAMBI BT	48 DV48V	R Recessed Mount	04 4W Power	B3 Bridgelux 3535	90 90+ CRI	135 135 Lumens

DESCRIPTION

Step into the world of FreePoint, where lighting isn't just about seeing, it's about feeling. Our 48V recessed system is more than just a collection of lights – it's a canvas for your imagination. From the sleek elegance of our spotlights to the warm glow of our decorative lights, FreePoint is designed to blend seamlessly into your life, enhancing every space with a touch of sophistication.

Crafting Light, Creating Atmosphere.

SPECIFICATIONS DATA

Installation	Ceiling
Size(s)	Ø1.14" x 3.39" L
Luminous Flux (lm)	135
Efficacy	45 LM/W
Finish(es)	Black
Dimming + Control(s)	Non-Dimming; 1-10V; DALI-2; Tuya; CASAMBI
Input Voltage	DC48V
Beam Angle	15°; 25°
UGR	<10
CRI	>90
CCT	27K; 30K; 35K; 40K
Power (W)	3
Application(s)	Indoor (IP20)

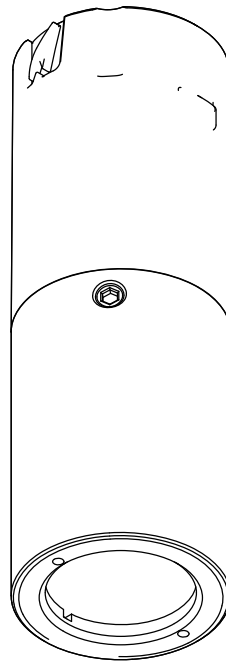
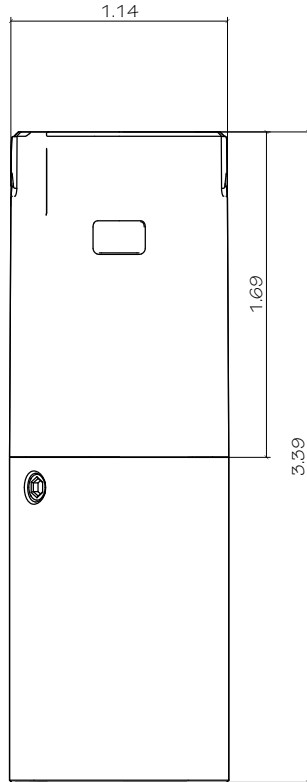



Ø1" Round Neon

FREEPOINT™ FEATURES

48V Flexible Recessed System: Offers a flexible and easy-to-integrate solution for various optical modules, enabling product re-use and low-cost light replacement.

Easy Assembly and Disassembly: Simplifies installation and maintenance with user-friendly assembly and disassembly features.

DALI-2 Compatibility: Supports advanced DALI-2 dimming protocols for enhanced lighting control.

Variety of Lighting Options: Includes single-hole spotlights, linear lights, and decorative lights, offering a wide range of lighting possibilities.

Trim-less Recessed Installation: Provides a clean, seamless look in ceiling installations.

Robust Construction: Features easy electrical connection, a strong base for light modules, and a load-bearing buckle supporting up to 10kg.

Optics Customization: Offers a choice of 23 professional optics, enabling tailored lighting solutions for different applications.

TRACK MODULE ORDERING GUIDE

F-[PG][Model]-[CCT]-[BA]-[DM][IV][IM][TP][LE][CRI]-[Lumens]-[Finish]

EX: F-RN1639-27-360-N48C12B90-840-B

DESCRIPTION

Step into the world of FreePoint, where lighting isn't just about seeing, it's about feeling. Our 48V recessed system is more than just a collection of lights – it's a canvas for your imagination. From the sleek elegance of our spotlights to the warm glow of our decorative lights, FreePoint is designed to blend seamlessly into your life, enhancing every space with a touch of sophistication.

Crafting Light, Creating Atmosphere.

SPECIFICATIONS DATA

Installation	Ceiling
Size(s)	Ø0.98" x 39/98/197" L
Luminous Flux (lm)	840 (39); 2100 (98); 4200 (197)
Efficacy	70 LM/W
Finish(es)	Black
Dimming + Control(s)	Non-Dimming; 1-10V; DALI-2; Tuya; CASAMBI
Input Voltage	DC48V
Beam Angle	360°
UGR	/
CRI	>90
CCT	27K; 30K; 35K; 40K
Power (W)	12 (39); 30 (98); 60 (197)
Application(s)	Indoor (IP20)

Product Group (PG)	Model (Model)	CCT (CCT)	Beam Angle (BA)	Dimming (DM)	Input Voltage (IV)	Installation Method (IM)	Typical Power (TP)	Light Engine (LE)	CRI (CRI)	Luminous Flux (Lumens)	
RN Round Neon	1639 Ø1.57" Housing; 39.37" Length	27 27K	360 360° Beam Angle	N Non-Dimming V 1-10V Dimming D DALI-2 T Tuya BT C CASAMBI BT	48 DV48V	C Ceiling Mount	12 12W Power (1639)	B2 Bridgelux 2835	90 90+ CRI	840 840 Lumens (1639) 2100 2100 Lumens (1698) 4200 4200 Lumens (16197)	
	1698 Ø1.57" Housing; 98.43" Length	30 30K									30 30W Power (1698)
	16197 Ø1.57" Housing; 196.85" Length	35 35K									60 60W Power (16197)
		40 40K									

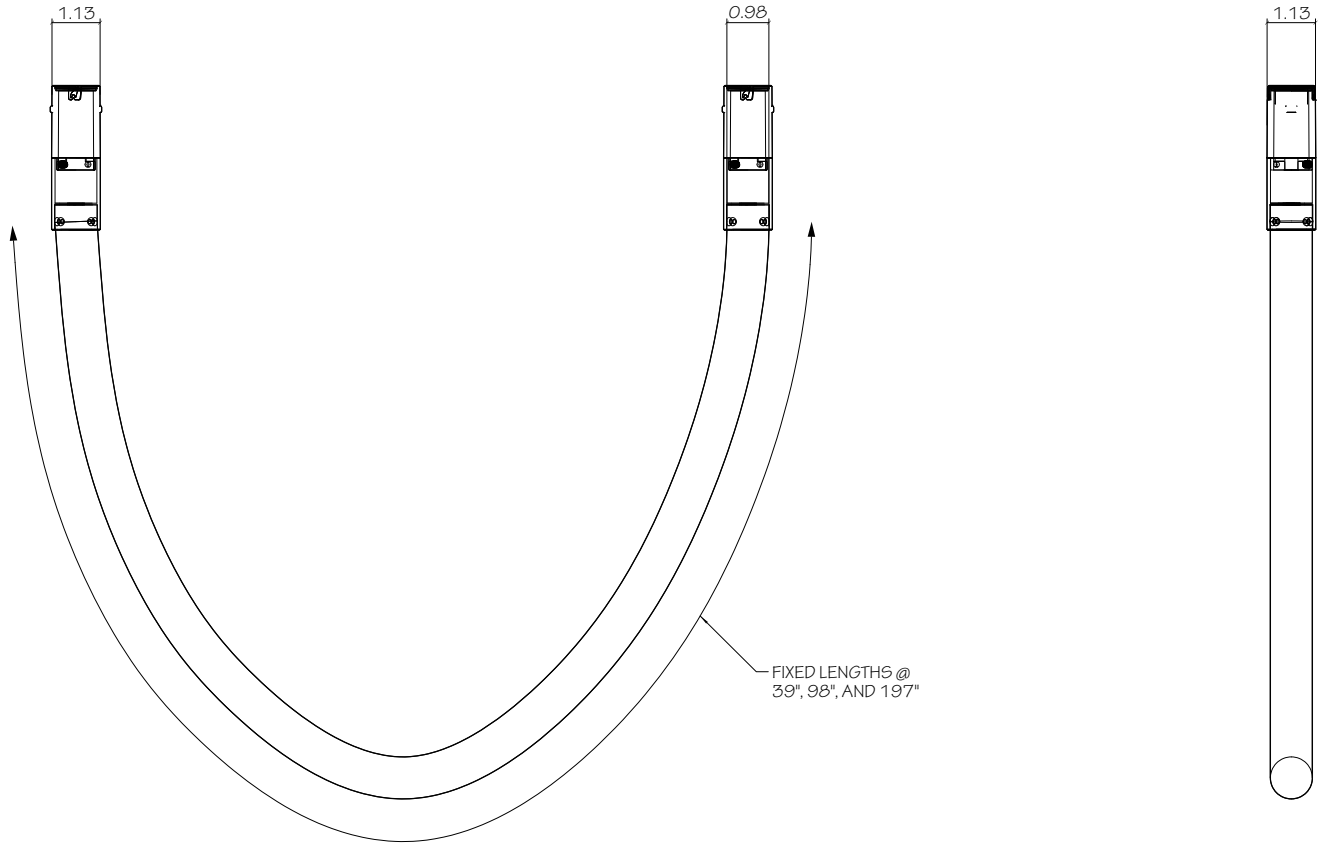

FIXED LENGTHS @
39", 98", AND 197"



Ø1.18" Pendant Light

FREEPOINT™ FEATURES

48V Flexible Recessed System: Offers a flexible and easy-to-integrate solution for various optical modules, enabling product re-use and low-cost light replacement.

Easy Assembly and Disassembly: Simplifies installation and maintenance with user-friendly assembly and disassembly features.

DALI-2 Compatibility: Supports advanced DALI-2 dimming protocols for enhanced lighting control.

Variety of Lighting Options: Includes single-hole spotlights, linear lights, and decorative lights, offering a wide range of lighting possibilities.

Trim-less Recessed Installation: Provides a clean, seamless look in ceiling installations.

Robust Construction: Features easy electrical connection, a strong base for light modules, and a load-bearing buckle supporting up to 10kg.

Optics Customization: Offers a choice of 23 professional optics, enabling tailored lighting solutions for different applications.

TRACK MODULE ORDERING GUIDE

F-[PG][Model]-[CCT]-[BA]-[DM][IV][IM][TP][LE][CRI]-[Lumens]-[Finish]

EX: F-P1612-27-24-N48P06BC90-390-B

Product Group (PG)	Model (Model)	CCT (CCT)	Beam Angle (BA)	Dimming (DM)	Input Voltage (IV)	Installation Method (IM)	Typical Power (TP)	Light Engine (LE)	CRI (CRI)	Luminous Flux (Lumens)
P Pendant Light	1612 Ø1.57" Housing; Ø1.18" Pendant; 11.81" Length	27 27K 30 30K 35 35K 40 40K	24 24° Beam Angle 36 36° Beam Angle	N Non-Dimming V 1-10V Dimming D DALI-2 T Tuya BT C CASAMBI BT	48 DV48V	P Pendant Mount	06 6W Power	BC Bridgelux COB	90 90+ CRI	390 390 Lumens

DESCRIPTION

Step into the world of FreePoint, where lighting isn't just about seeing, it's about feeling. Our 48V recessed system is more than just a collection of lights – it's a canvas for your imagination. From the sleek elegance of our spotlights to the warm glow of our decorative lights, FreePoint is designed to blend seamlessly into your life, enhancing every space with a touch of sophistication.

Crafting Light, Creating Atmosphere.

SPECIFICATIONS DATA

Installation	Pendant
Size(s)	Ø1.18" x 11.81" L
Luminous Flux (lm)	390
Efficacy	65 LM/W
Finish(es)	Black
Dimming + Control(s)	Non-Dimming; 1-10V; DALI-2; Tuya; CASAMBI
Input Voltage	DC48V
Beam Angle	24°; 36°
UGR	<10
CRI	>90
CCT	27K; 30K; 35K; 40K
Power (W)	6
Application(s)	Indoor (IP20)

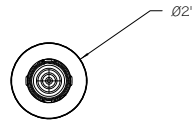

1 FREEPOINT LINEAR MODULE - BOTTOM

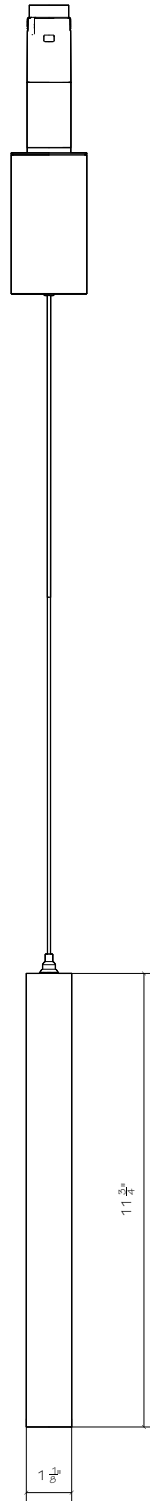

2 FREEPOINT PENDANT MODULE - ELEVATION
www.epl.com



Ø1.97" Pendant Light

FREEPOINT™ FEATURES

48V Flexible Recessed System: Offers a flexible and easy-to-integrate solution for various optical modules, enabling product re-use and low-cost light replacement.

Easy Assembly and Disassembly: Simplifies installation and maintenance with user-friendly assembly and disassembly features.

DALI-2 Compatibility: Supports advanced DALI-2 dimming protocols for enhanced lighting control.

Variety of Lighting Options: Includes single-hole spotlights, linear lights, and decorative lights, offering a wide range of lighting possibilities.

Trim-less Recessed Installation: Provides a clean, seamless look in ceiling installations.

Robust Construction: Features easy electrical connection, a strong base for light modules, and a load-bearing buckle supporting up to 10kg.

Optics Customization: Offers a choice of 23 professional optics, enabling tailored lighting solutions for different applications.

TRACK MODULE ORDERING GUIDE

F-[PG][Model]-[CCT]-[BA]-[DM][IV][IM][TP][LE][CRI]-[Lumens]-[Finish]

EX: F-P1620-27-24-N48P06BC90-390-B

Product Group (PG)	Model (Model)	CCT (CCT)	Beam Angle (BA)	Dimming (DM)	Input Voltage (IV)	Installation Method (IM)	Typical Power (TP)	Light Engine (LE)	CRI (CRI)	Luminous Flux (Lumens)
P Pendant Light	1620 Ø1.57" Housing; Ø1.97" Pendant; 11.81" Length	27 27K 30 30K 35 35K 40 40K	24 24° Beam Angle 36 36° Beam Angle	N Non-Dimming V 1-10V Dimming D DALI-2 T Tuya BT C CASAMBI BT	48 DV48V	P Pendant Mount	06 6W Power	BC Bridgelux COB	90 90+ CRI	390 390 Lumens

DESCRIPTION

Step into the world of FreePoint, where lighting isn't just about seeing, it's about feeling. Our 48V recessed system is more than just a collection of lights – it's a canvas for your imagination. From the sleek elegance of our spotlights to the warm glow of our decorative lights, FreePoint is designed to blend seamlessly into your life, enhancing every space with a touch of sophistication.

Crafting Light, Creating Atmosphere.

SPECIFICATIONS DATA

Installation	Pendant
Size(s)	Ø1.97" x 11.81" L
Luminous Flux (lm)	390
Efficacy	65 LM/W
Finish(es)	Black
Dimming + Control(s)	Non-Dimming; 1-10V; DALI-2; Tuya; CASAMBI
Input Voltage	DC48V
Beam Angle	24°; 36°
UGR	<10
CRI	>90
CCT	27K; 30K; 35K; 40K
Power (W)	6
Application(s)	Indoor (IP20)

1 FREEPOINT PENDANT MODULE - 2" - ELEVATION

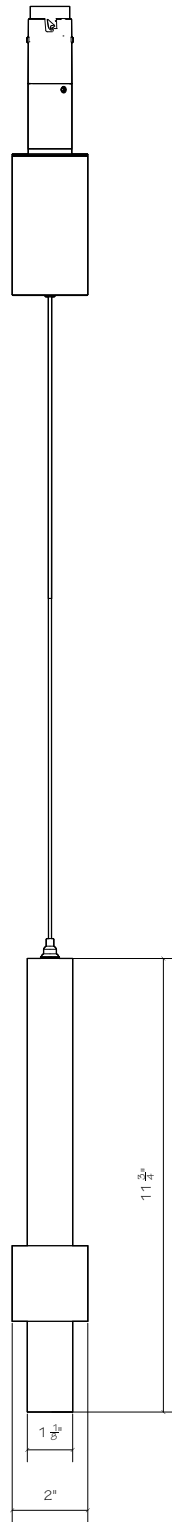

2 FREEPOINT PENDANT MODULE - 2" - BOTTOM
www.epl.com

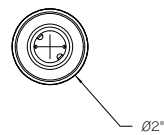



Ø1.18" Round Neon Pendant

FREEPOINT™ FEATURES

48V Flexible Recessed System: Offers a flexible and easy-to-integrate solution for various optical modules, enabling product re-use and low-cost light replacement.

Easy Assembly and Disassembly: Simplifies installation and maintenance with user-friendly assembly and disassembly features.

DALI-2 Compatibility: Supports advanced DALI-2 dimming protocols for enhanced lighting control.

Variety of Lighting Options: Includes single-hole spotlights, linear lights, and decorative lights, offering a wide range of lighting possibilities.

Trim-less Recessed Installation: Provides a clean, seamless look in ceiling installations.

Robust Construction: Features easy electrical connection, a strong base for light modules, and a load-bearing buckle supporting up to 10kg.

Optics Customization: Offers a choice of 23 professional optics, enabling tailored lighting solutions for different applications.

TRACK MODULE ORDERING GUIDE

F-[PG][Model]-[CCT]-[BA]-[DM][IV][IM][TP][LE][CRI]-[Lumens]-[Finish]

EX: F-RNP1612-27-360-N48P07B290-490-B

Product Group (PG)	Model (Model)	CCT (CCT)	Beam Angle (BA)	Dimming (DM)	Input Voltage (IV)	Installation Method (IM)	Typical Power (TP)	Light Engine (LE)	CRI (CRI)	Luminous Flux (Lumens)
RNP Round Neon Pendant Light	1612 Ø1.57" Housing; Ø1.18" Pendant; 20.79" Length	27 27K 30 30K 35 35K 40 40K	360 360° Beam Angle	N Non-Dimming V 1-10V Dimming D DALI-2 T Tuya BT C CASAMBI BT	48 DV48V	P Pendant Mount	07 7W Power	B2 Bridgelux 2835	90 90+ CRI	490 490 Lumens

DESCRIPTION

Step into the world of FreePoint, where lighting isn't just about seeing, it's about feeling. Our 48V recessed system is more than just a collection of lights – it's a canvas for your imagination. From the sleek elegance of our spotlights to the warm glow of our decorative lights, FreePoint is designed to blend seamlessly into your life, enhancing every space with a touch of sophistication.

Crafting Light, Creating Atmosphere.

SPECIFICATIONS DATA

Installation	Pendant
Size(s)	Ø1.18" x 20.79" L
Luminous Flux (lm)	490
Efficacy	70 LM/W
Finish(es)	Black
Dimming + Control(s)	Non-Dimming; 1-10V; DALI-2; Tuya; CASAMBI
Input Voltage	DC48V
Beam Angle	360°
UGR	/
CRI	>90
CCT	27K; 30K; 35K; 40K
Power (W)	7
Application(s)	Indoor (IP20)

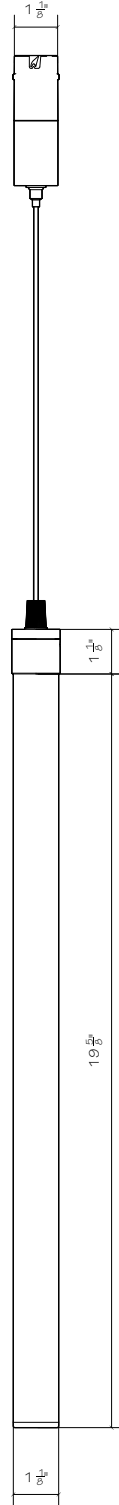
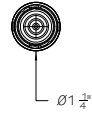

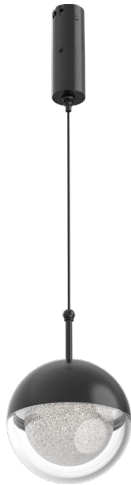

Ø3.94" Decorative Sphere Lamp

FREEPOINT™ FEATURES

48V Flexible Recessed System: Offers a flexible and easy-to-integrate solution for various optical modules, enabling product re-use and low-cost light replacement.

Easy Assembly and Disassembly: Simplifies installation and maintenance with user-friendly assembly and disassembly features.

DALI-2 Compatibility: Supports advanced DALI-2 dimming protocols for enhanced lighting control.

Variety of Lighting Options: Includes single-hole spotlights, linear lights, and decorative lights, offering a wide range of lighting possibilities.

Trim-less Recessed Installation: Provides a clean, seamless look in ceiling installations.

Robust Construction: Features easy electrical connection, a strong base for light modules, and a load-bearing buckle supporting up to 10kg.

Optics Customization: Offers a choice of 23 professional optics, enabling tailored lighting solutions for different applications.

TRACK MODULE ORDERING GUIDE

F-[PG][Model]-[CCT]-[BA]-[DM][IV][IM][TP][LE][CRI]-[Lumens]-[Finish]

EX: F-DESPH1639-27-360-N48C06B290-600-B

DESCRIPTION

Step into the world of FreePoint, where lighting isn't just about seeing, it's about feeling. Our 48V recessed system is more than just a collection of lights – it's a canvas for your imagination. From the sleek elegance of our spotlights to the warm glow of our decorative lights, FreePoint is designed to blend seamlessly into your life, enhancing every space with a touch of sophistication.

Crafting Light, Creating Atmosphere.

SPECIFICATIONS DATA

Installation	Ceiling
Size(s)	Ø3.94" x Adjustable Cable Length up to 47.24"
Luminous Flux (lm)	600
Efficacy	100 LM/W
Finish(es)	Black
Dimming + Control(s)	Non-Dimming; 1-10V; DALI-2; Tuya; CASAMBI
Input Voltage	DC48V
Beam Angle	360°
UGR	/
CRI	>90
CCT	27K; 30K; 35K; 40K
Power (W)	6
Application(s)	Indoor (IP20)

Product Group (PG)	Model (Model)	CCT (CCT)	Beam Angle (BA)	Dimming (DM)	Input Voltage (IV)	Installation Method (IM)	Typical Power (TP)	Light Engine (LE)	CRI (CRI)	Luminous Flux (Lumens)
DESPH Decorative Sphere Lamp	1639 Ø1.57" Housing; Ø3.94" Sphere	27 27K 30 30K 35 35K 40 40K	360 360° Beam Angle	N Non-Dimming V 1-10V Dimming D DALI-2 T Tuya BT C CASAMBI BT	48 DV48V	C Ceiling Mount	06 6W Power	B2 Bridgelux 2835	90 90+ CRI	600 600 Lumens

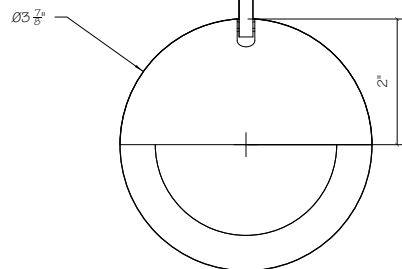
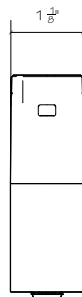
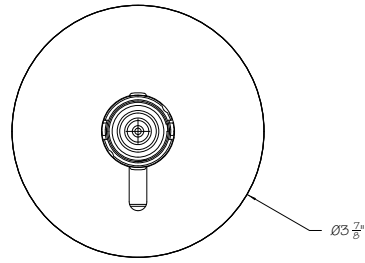



Ø1.57" Decorative Waterdrop Lamp

FREEPOINT™ FEATURES

48V Flexible Recessed System: Offers a flexible and easy-to-integrate solution for various optical modules, enabling product re-use and low-cost light replacement.

Easy Assembly and Disassembly: Simplifies installation and maintenance with user-friendly assembly and disassembly features.

DALI-2 Compatibility: Supports advanced DALI-2 dimming protocols for enhanced lighting control.

Variety of Lighting Options: Includes single-hole spotlights, linear lights, and decorative lights, offering a wide range of lighting possibilities.

Trim-less Recessed Installation: Provides a clean, seamless look in ceiling installations.

Robust Construction: Features easy electrical connection, a strong base for light modules, and a load-bearing buckle supporting up to 10kg.

Optics Customization: Offers a choice of 23 professional optics, enabling tailored lighting solutions for different applications.

TRACK MODULE ORDERING GUIDE

F-[PG][Model]-[CCT]-[BA]-[DM][IV][IM][TP][LE][CRI]-[Lumens]-[Finish]

EX: F-DEWP1616-27-110-N48P04BC90-360-B

Product Group (PG)	Model (Model)	CCT (CCT)	Beam Angle (BA)	Dimming (DM)	Input Voltage (IV)	Installation Method (IM)	Typical Power (TP)	Light Engine (LE)	CRI (CRI)	Luminous Flux (Lumens)
DEWP Decorative Waterdrop Lamp	1616 Ø1.57" Housing; Ø1.57" Waterdrop x 4.08" H	27 27K 30 30K 35 35K 40 40K	110 110° Beam Angle	N Non-Dimming V 1-10V Dimming D DALI-2 T Tuya BT C CASAMBI BT	48 DV48V	P Pendant Mount	04 4W Power	BC Bridgelux COB	90 90+ CRI	360 360 Lumens

DESCRIPTION

Step into the world of FreePoint, where lighting isn't just about seeing, it's about feeling. Our 48V recessed system is more than just a collection of lights – it's a canvas for your imagination. From the sleek elegance of our spotlights to the warm glow of our decorative lights, FreePoint is designed to blend seamlessly into your life, enhancing every space with a touch of sophistication.

Crafting Light, Creating Atmosphere.

SPECIFICATIONS DATA

Installation	Pendant
Size(s)	Ø1.57" x 4.08"H
Luminous Flux (lm)	360
Efficacy	90 LM/W
Finish(es)	Black
Dimming + Control(s)	Non-Dimming; 1-10V; DALI-2; Tuya; CASAMBI
Input Voltage	DC48V
Beam Angle	110°
UGR	/
CRI	>90
CCT	27K; 30K; 35K; 40K
Power (W)	4
Application(s)	Indoor (IP20)

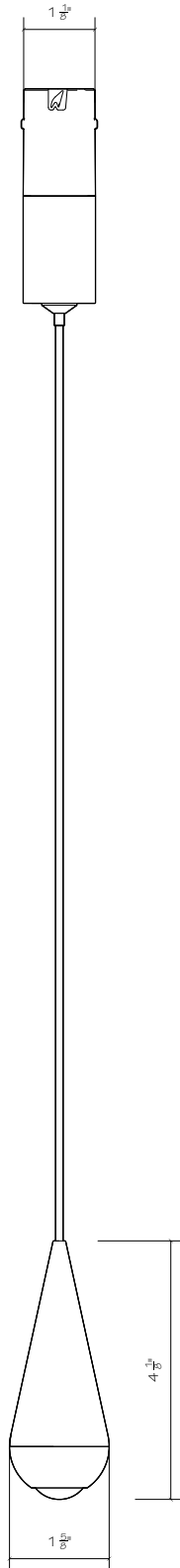
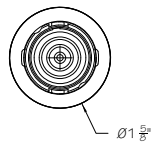



Ø2.17" Decorative Sunset Lamp

FREEPOINT™ FEATURES

48V Flexible Recessed System: Offers a flexible and easy-to-integrate solution for various optical modules, enabling product re-use and low-cost light replacement.

Easy Assembly and Disassembly: Simplifies installation and maintenance with user-friendly assembly and disassembly features.

DALI-2 Compatibility: Supports advanced DALI-2 dimming protocols for enhanced lighting control.

Variety of Lighting Options: Includes single-hole spotlights, linear lights, and decorative lights, offering a wide range of lighting possibilities.

Trim-less Recessed Installation: Provides a clean, seamless look in ceiling installations.

Robust Construction: Features easy electrical connection, a strong base for light modules, and a load-bearing buckle supporting up to 10kg.

Optics Customization: Offers a choice of 23 professional optics, enabling tailored lighting solutions for different applications.

TRACK MODULE ORDERING GUIDE

F-[PG][Model]-[CCT]-[BA]-[DM][IV][IM][TP][LE][CRI]-[Lumens]-[Finish]

EX: F-DESU1622-27-110-N48C03BC90-170-B

Product Group (PG)	Model (Model)	CCT (CCT)	Beam Angle (BA)	Dimming (DM)	Input Voltage (IV)	Installation Method (IM)	Typical Power (TP)	Light Engine (LE)	CRI (CRI)	Luminous Flux (Lumens)
DESU Decorative Sunset Lamp	1622 Ø1.57" Housing; Ø2.17" Sunset x 0.9" D	27 27K 30 30K 35 35K 40 40K	110 110° Beam Angle	N Non-Dimming V 1-10V Dimming D DALI-2 T Tuya BT C CASAMBI BT	48 DV48V	C Ceiling Mount	03 3W Power	BC Bridgelux COB	90 90+ CRI	170 170 Lumens

DESCRIPTION

Step into the world of FreePoint, where lighting isn't just about seeing, it's about feeling. Our 48V recessed system is more than just a collection of lights – it's a canvas for your imagination. From the sleek elegance of our spotlights to the warm glow of our decorative lights, FreePoint is designed to blend seamlessly into your life, enhancing every space with a touch of sophistication.

Crafting Light, Creating Atmosphere.

SPECIFICATIONS DATA

Installation	Ceiling
Size(s)	Ø2.17" x 0.9" D
Luminous Flux (lm)	170
Efficacy	57 LM/W
Finish(es)	Black
Dimming + Control(s)	Non-Dimming; 1-10V; DALI-2; Tuya; CASAMBI
Input Voltage	DC48V
Beam Angle	110°
UGR	/
CRI	>90
CCT	27K; 30K; 35K; 40K
Power (W)	3
Application(s)	Indoor (IP20)

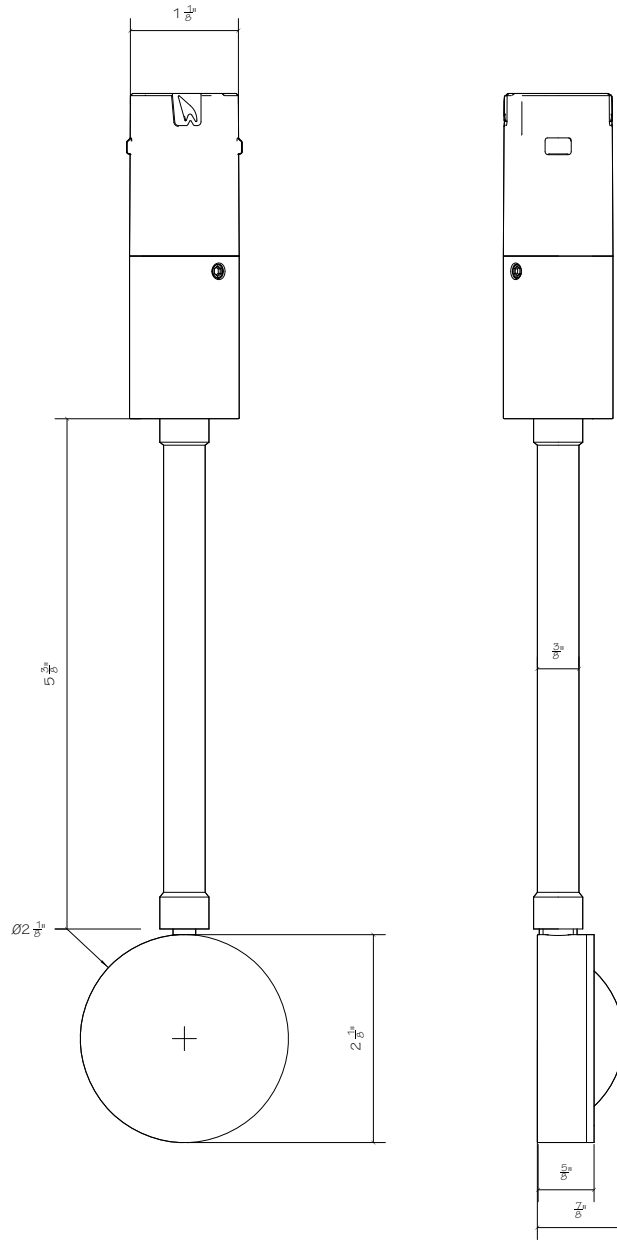



Linear Wall Grazer

FREEPOINT™ FEATURES

48V Flexible Recessed System: Offers a flexible and easy-to-integrate solution for various optical modules, enabling product re-use and low-cost light replacement.

Easy Assembly and Disassembly: Simplifies installation and maintenance with user-friendly assembly and disassembly features.

DALI-2 Compatibility: Supports advanced DALI-2 dimming protocols for enhanced lighting control.

Variety of Lighting Options: Includes single-hole spotlights, linear lights, and decorative lights, offering a wide range of lighting possibilities.

Trim-less Recessed Installation: Provides a clean, seamless look in ceiling installations.

Robust Construction: Features easy electrical connection, a strong base for light modules, and a load-bearing buckle supporting up to 10kg.

Optics Customization: Offers a choice of 23 professional optics, enabling tailored lighting solutions for different applications.

TRACK MODULE ORDERING GUIDE

F-[PG][Model]-[CCT]-[BA]-[DM][IV][IM][TP][LE][CRI]-[Lumens]-[Finish]

EX: F-LNWG16238-27-602573-N48C100390-900-B

Product Group (PG)	Model (Model)	CCT (CCT)	Beam Angle (BA)	Dimming (DM)	Input Voltage (IV)	Installation Method (IM)	Typical Power (TP)	Light Engine (LE)	CRI (CRI)	Luminous Flux (Lumens)
LNWG Linear Wall Grazer	16238 Ø1.57" Housing; 23.8" Length Wall Grazer	27 27K 30 30K	602573 60° x 25° x 73° Beam Angle	N Non-Dimming V 1-10V Dimming D DALI-2 T Tuya BT C CASAMBI BT	48 DV48V	C Ceiling Mount	10 10W Power (16238)	O3 OSRAM 3030	90 90+ CRI	900 900 Lumens (16238)
	16474 Ø1.57" Housing; 47.4" Length Wall Grazer	35 35K 40 40K					20 20W Power (16474)			1800 1800 Lumens (16474)

DESCRIPTION

Step into the world of FreePoint, where lighting isn't just about seeing, it's about feeling. Our 48V recessed system is more than just a collection of lights – it's a canvas for your imagination. From the sleek elegance of our spotlights to the warm glow of our decorative lights, FreePoint is designed to blend seamlessly into your life, enhancing every space with a touch of sophistication.

Crafting Light, Creating Atmosphere.

SPECIFICATIONS DATA

Installation	Ceiling
Size(s)	0.91" W x 5.67" H x 23.78"/47.4" L
Luminous Flux (lm)	900 (16238); 1800 (16474)
Efficacy	90 LM/W
Finish(es)	Black
Dimming + Control(s)	Non-Dimming; 1-10V; DALI-2; Tuya; CASAMBI
Input Voltage	DC48V
Beam Angle	60° x 25° x 73°
UGR	/
CRI	>90
CCT	27K; 30K; 35K; 40K
Power (W)	10 (16238); 20 (16474)
Application(s)	Indoor (IP20)

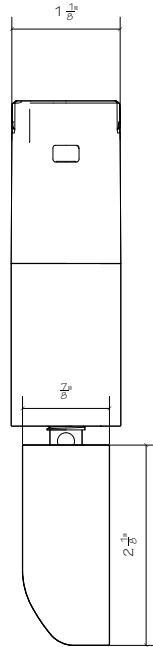

① WALLGRAZER SIDE ELEVATION
1:2

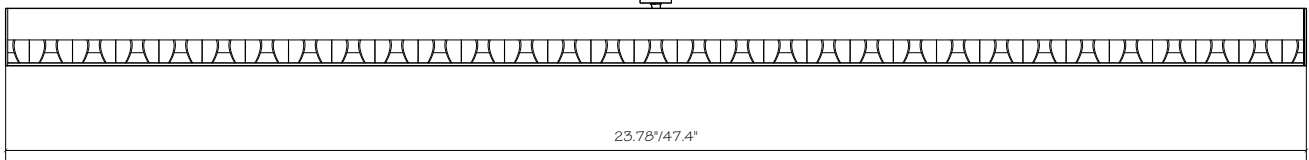

② WALLGRAZER FRONT ELEVATION
1:7



Ø1.18" Round Neon Tube

FREEPOINT™ FEATURES

48V Flexible Recessed System: Offers a flexible and easy-to-integrate solution for various optical modules, enabling product re-use and low-cost light replacement.

Easy Assembly and Disassembly: Simplifies installation and maintenance with user-friendly assembly and disassembly features.

DALI-2 Compatibility: Supports advanced DALI-2 dimming protocols for enhanced lighting control.

Variety of Lighting Options: Includes single-hole spotlights, linear lights, and decorative lights, offering a wide range of lighting possibilities.

Trim-less Recessed Installation: Provides a clean, seamless look in ceiling installations.

Robust Construction: Features easy electrical connection, a strong base for light modules, and a load-bearing buckle supporting up to 10kg.

Optics Customization: Offers a choice of 23 professional optics, enabling tailored lighting solutions for different applications.

TRACK MODULE ORDERING GUIDE

F-[PG][Model]-[CCT]-[BA]-[DM][IV][IM][TP][LE][CRI]-[Lumens]-[Finish]

EX: F-RNT161224-27-200110-N48C12B290-1200-B

DESCRIPTION

Step into the world of FreePoint, where lighting isn't just about seeing, it's about feeling. Our 48V recessed system is more than just a collection of lights – it's a canvas for your imagination. From the sleek elegance of our spotlights to the warm glow of our decorative lights, FreePoint is designed to blend seamlessly into your life, enhancing every space with a touch of sophistication.

Crafting Light, Creating Atmosphere.

SPECIFICATIONS DATA

Installation	Ceiling
Size(s)	Ø1.18" x 23.78"/35.59"/47.4" L
Luminous Flux (lm)	1200 (161224); 1800 (161236); 2400 (161248)
Efficacy	100 LM/W
Finish(es)	Black
Dimming + Control(s)	Non-Dimming; 1-10V; DALI-2; Tuya; CASAMBI
Input Voltage	DC48V
Beam Angle	200° x 110°
UGR	/
CRI	>90
CCT	27K; 30K; 35K; 40K
Power (W)	12 (161224); 18 (161236); 24 (161248)
Application(s)	Indoor (IP20)

Product Group (PG)	Model (Model)	CCT (CCT)	Beam Angle (BA)	Dimming (DM)	Input Voltage (IV)	Installation Method (IM)	Typical Power (TP)	Light Engine (LE)	CRI (CRI)	Luminous Flux (Lumens)
RNT Round Neon Tube	161224	27	200110 200° x 110° Beam Angle	N	48 DV48V	C Ceiling Mount	12	B2 Bridgelux 2835	90 90+ CRI	1200
	Ø1.57" Housing; 23.78" Length	27K		Non-Dimming			12W Power (161224)			1200 Lumens (161224)
	161236	30		V			18			1800
	Ø1.57" Housing; 35.59" Length	30K		1-10V Dimming			18W Power (161236)			1800 Lumens (161236)
161248	40	D	24	2400						
Ø1.57" Housing; 47.4" Length	40K	T	24W Power (161248)	2400 Lumens (161248)						
			C							
				CASAMBI BT						



FREE™ Series

LINE DRAWING(S)

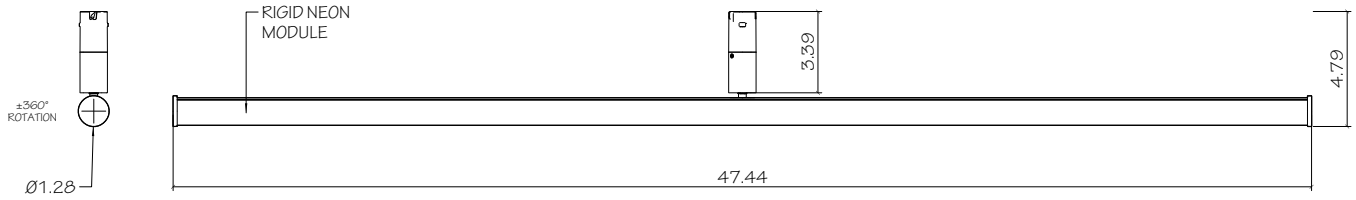



Single-Hole Linear Module (Frosted Diffuser)

FREEPOINT™ FEATURES

48V Flexible Recessed System: Offers a flexible and easy-to-integrate solution for various optical modules, enabling product re-use and low-cost light replacement.

Easy Assembly and Disassembly: Simplifies installation and maintenance with user-friendly assembly and disassembly features.

DALI-2 Compatibility: Supports advanced DALI-2 dimming protocols for enhanced lighting control.

Variety of Lighting Options: Includes single-hole spotlights, linear lights, and decorative lights, offering a wide range of lighting possibilities.

Trim-less Recessed Installation: Provides a clean, seamless look in ceiling installations.

Robust Construction: Features easy electrical connection, a strong base for light modules, and a load-bearing buckle supporting up to 10kg.

Optics Customization: Offers a choice of 23 professional optics, enabling tailored lighting solutions for different applications.

TRACK MODULE ORDERING GUIDE

F-[PG][Model]-[CCT]-[BA]-[DM][IV][IM][TP][LE][CRI]-[Lumens]-[Finish]

EX: F-LNSHFD-1624-110-27-N48C12B290-900-B

Product Group (PG)	Model (Model)	CCT (CCT)	Beam Angle (BA)	Dimming (DM)	Input Voltage (IV)	Installation Method (IM)	Typical Power (TP)	Light Engine (LE)	CRI (CRI)	Luminous Flux (Lumens)
LNSHFD Single-Hole Linear Module; Frosted Diffuser Lens	1624 Ø1.57" Housing; 24" Length	27 27K	110 110° Beam Angle	N Non-Dimming	48 DV48V	C Ceiling Mount	12 12W Power (1624)	B2 Bridgelux 2835	90 90+ CRI	900 900 Lumens (1624)
	1635 Ø1.57" Housing; 35" Length	30 30K		V 1-10V Dimming			18 18W Power (1635)			1350 1350 Lumens (1635)
	1647 Ø1.57" Housing; 47" Length	35 35K		D DALI-2			24 24W Power (1647)			1800 1800 Lumens (1647)
		40 40K		T Tuya BT						
				C CASAMBI BT						

DESCRIPTION

Step into the world of FreePoint, where lighting isn't just about seeing, it's about feeling. Our 48V recessed system is more than just a collection of lights – it's a canvas for your imagination. From the sleek elegance of our spotlights to the warm glow of our decorative lights, FreePoint is designed to blend seamlessly into your life, enhancing every space with a touch of sophistication.

Crafting Light, Creating Atmosphere.

SPECIFICATIONS DATA

Installation	Ceiling
Size(s)	0.91" x 0.89" x 24"/35"/47" L
Luminous Flux (lm)	900 (1624); 1350 (1635); 1800 (1647)
Efficacy	75 LM/W
Finish(es)	Black
Dimming + Control(s)	Non-Dimming; 1-10V; DALI-2; Tuya; CASAMBI
Input Voltage	DC48V
Beam Angle	110°
UGR	/
CRI	>90
CCT	27K; 30K; 35K; 40K
Power (W)	12 (1624); 18 (1635); 24 (1647)
Application(s)	Indoor (IP20)

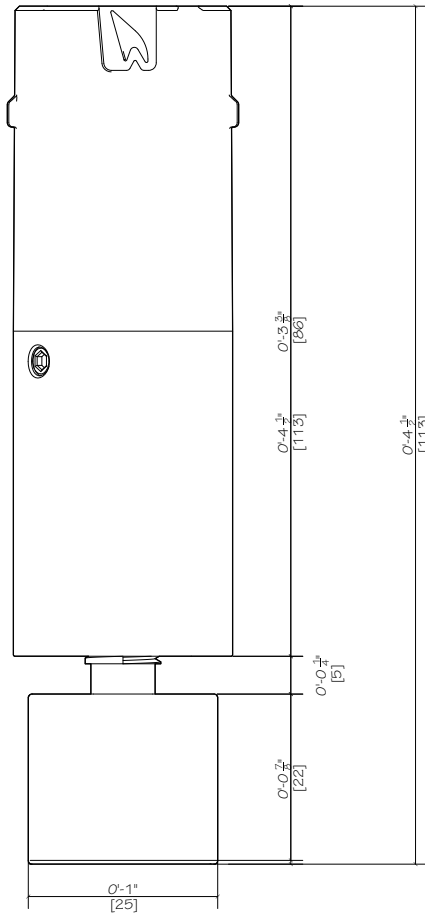

01 FREEPOINT LINEAR MODULE - FRONT ELEVATION
1:1

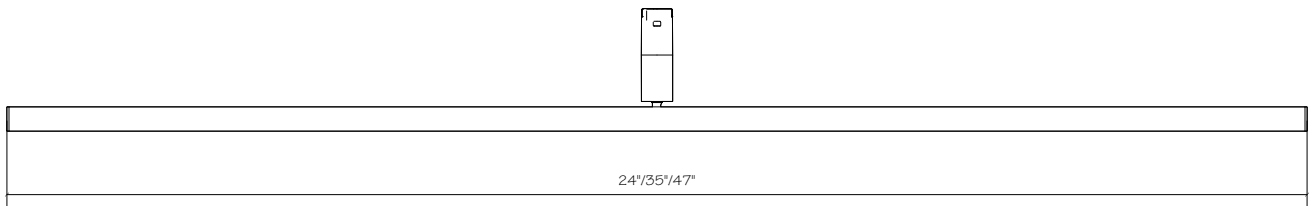

02 FREEPOINT LINEAR MODULE - ELEVATION
1:7



Single-Hole Linear Module (Microprismatic)

FREEPOINT™ FEATURES

48V Flexible Recessed System: Offers a flexible and easy-to-integrate solution for various optical modules, enabling product re-use and low-cost light replacement.

Easy Assembly and Disassembly: Simplifies installation and maintenance with user-friendly assembly and disassembly features.

DALI-2 Compatibility: Supports advanced DALI-2 dimming protocols for enhanced lighting control.

Variety of Lighting Options: Includes single-hole spotlights, linear lights, and decorative lights, offering a wide range of lighting possibilities.

Trim-less Recessed Installation: Provides a clean, seamless look in ceiling installations.

Robust Construction: Features easy electrical connection, a strong base for light modules, and a load-bearing buckle supporting up to 10kg.

Optics Customization: Offers a choice of 23 professional optics, enabling tailored lighting solutions for different applications.

TRACK MODULE ORDERING GUIDE

F-[PG][Model]-[CCT]-[BA]-[DM][IV][IM][TP][LE][CRI]-[Lumens]-[Finish]

EX: F-LNSHFP-1624-27-70-N48C12B290-960-B

Product Group (PG)	Model (Model)	CCT (CCT)	Beam Angle (BA)	Dimming (DM)	Input Voltage (IV)	Installation Method (IM)	Typical Power (TP)	Light Engine (LE)	CRI (CRI)	Luminous Flux (Lumens)
LNSHFP Single-Hole Linear Module; Microprismatic Lens	1624 Ø1.57" Housing; 24" Length	27 27K	70 70° Beam Angle	N Non-Dimming	48 DV48V	C Ceiling Mount	12 12W Power (1624)	B2 Bridgelux 2835	90 90+ CRI	960 960 Lumens (1624)
	1635 Ø1.57" Housing; 35" Length	30 30K		V 1-10V Dimming			18 18W Power (1635)			1140 1140 Lumens (1635)
	1647 Ø1.57" Housing; 47" Length	35 35K		D DALI-2			24 24W Power (1647)			1920 1920 Lumens (1647)
		40 40K		T Tuya BT						
				C CASAMBI BT						

DESCRIPTION

Step into the world of FreePoint, where lighting isn't just about seeing, it's about feeling. Our 48V recessed system is more than just a collection of lights – it's a canvas for your imagination. From the sleek elegance of our spotlights to the warm glow of our decorative lights, FreePoint is designed to blend seamlessly into your life, enhancing every space with a touch of sophistication.

Crafting Light, Creating Atmosphere.

SPECIFICATIONS DATA

Installation	Ceiling
Size(s)	0.91" x 0.89" x 24"/35"/47" L
Luminous Flux (lm)	960 (1624); 1140 (1635); 1920 (1647)
Efficacy	80 LM/W
Finish(es)	Black
Dimming + Control(s)	Non-Dimming; 1-10V; DALI-2; Tuya; CASAMBI
Input Voltage	DC48V
Beam Angle	70°
UGR	/
CRI	>90
CCT	27K; 30K; 35K; 40K
Power (W)	12 (1624); 18 (1635); 24 (1647)
Application(s)	Indoor (IP20)



FREE™ Series

LINE DRAWING(S)

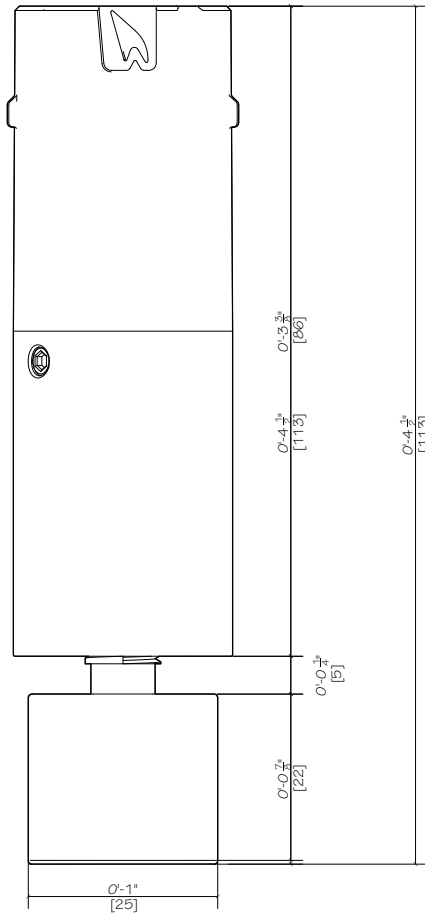

01 FREEPOINT LINEAR MODULE - FRONT ELEVATION
1:1

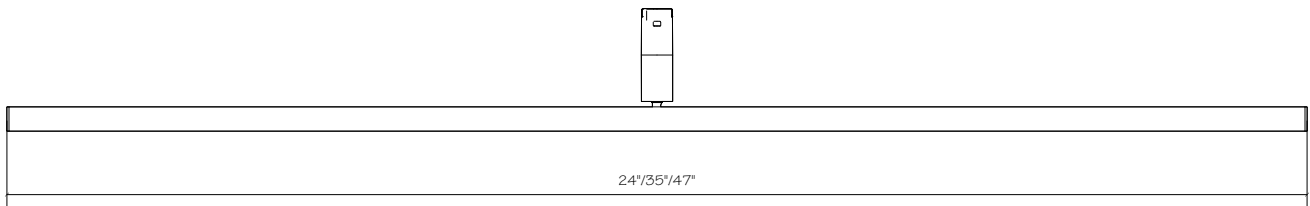

02 FREEPOINT LINEAR MODULE - ELEVATION
1:7



Single-Hole Linear Module (Microcell)

FREEPOINT™ FEATURES

48V Flexible Recessed System: Offers a flexible and easy-to-integrate solution for various optical modules, enabling product re-use and low-cost light replacement.

Easy Assembly and Disassembly: Simplifies installation and maintenance with user-friendly assembly and disassembly features.

DALI-2 Compatibility: Supports advanced DALI-2 dimming protocols for enhanced lighting control.

Variety of Lighting Options: Includes single-hole spotlights, linear lights, and decorative lights, offering a wide range of lighting possibilities.

Trim-less Recessed Installation: Provides a clean, seamless look in ceiling installations.

Robust Construction: Features easy electrical connection, a strong base for light modules, and a load-bearing buckle supporting up to 10kg.

Optics Customization: Offers a choice of 23 professional optics, enabling tailored lighting solutions for different applications.

TRACK MODULE ORDERING GUIDE

F-[PG][Model]-[CCT]-[BA]-[DM][IV][IM][TP][LE][CRI]-[Lumens]-[Finish]

EX: F-LNSHMC-1626-27-30-N48C13O290-910-B

Product Group (PG)	Model (Model)	CCT (CCT)	Beam Angle (BA)	Dimming (DM)	Input Voltage (IV)	Installation Method (IM)	Typical Power (TP)	Light Engine (LE)	CRI (CRI)	Luminous Flux (Lumens)
LNSHFP Single-Hole Linear Module; Microprismatic Lens	1626 Ø1.57" Housing; 26" Length	27 27K 30 30K	30 30° Beam Angle (1626) 55 55° Beam Angle (1651)	N Non-Dimming V 1-10V Dimming D DALI-2 T Tuya BT C CASAMBI BT	48 DV48V	C Ceiling Mount	13 13W Power (1626) 26 26W Power (1635)	O2 OSRAM 2835	90 90+ CRI	910 910 Lumens (1626) 1820 1820 Lumens (1651)
	1651 Ø1.57" Housing; 51" Length	35 35K 40 40K								

DESCRIPTION

Step into the world of FreePoint, where lighting isn't just about seeing, it's about feeling. Our 48V recessed system is more than just a collection of lights – it's a canvas for your imagination. From the sleek elegance of our spotlights to the warm glow of our decorative lights, FreePoint is designed to blend seamlessly into your life, enhancing every space with a touch of sophistication.

Crafting Light, Creating Atmosphere.

SPECIFICATIONS DATA

Installation	Ceiling
Size(s)	0.91" x 0.89" x 26"/51" L
Luminous Flux (lm)	910 (1626); 1820 (1651)
Efficacy	70 LM/W
Finish(es)	Black
Dimming + Control(s)	Non-Dimming; 1-10V; DALI-2; Tuya; CASAMBI
Input Voltage	DC48V
Beam Angle	30°; 55°
UGR	/
CRI	>90
CCT	27K; 30K; 35K; 40K
Power (W)	13 (1626); 26 (1651)
Application(s)	Indoor (IP20)



FREE™ Series

LINE DRAWING(S)

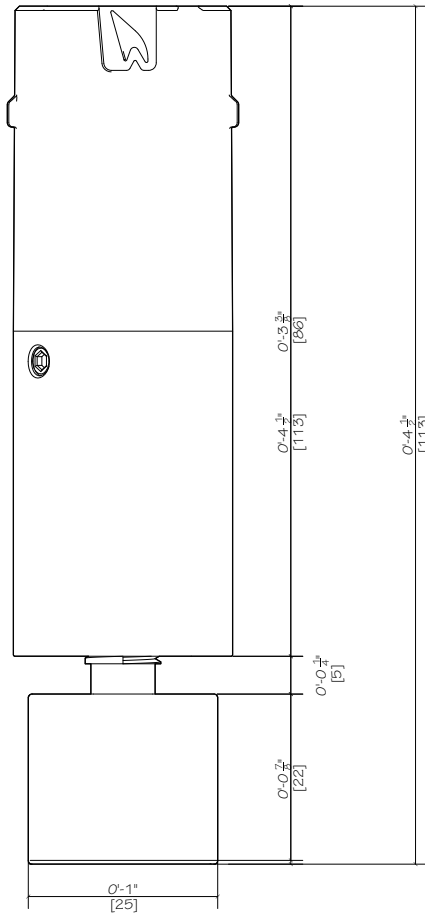

01 FREEPOINT LINEAR MODULE - FRONT ELEVATION
1:1

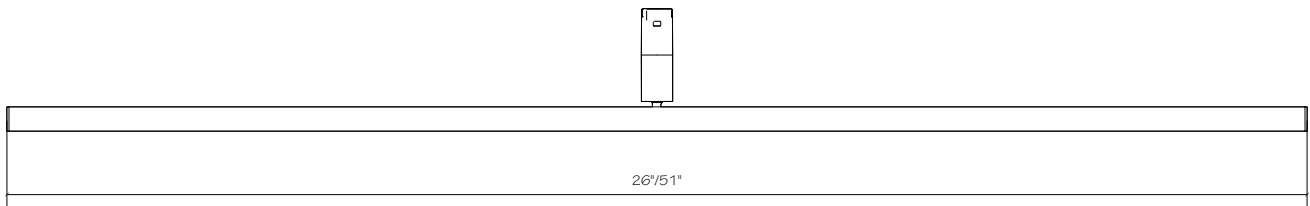

02 FREEPOINT LINEAR MODULE - ELEVATION
1:7



Single-Hole Linear Module (Wall Wash Lens)

FREEPOINT™ FEATURES

48V Flexible Recessed System: Offers a flexible and easy-to-integrate solution for various optical modules, enabling product re-use and low-cost light replacement.

Easy Assembly and Disassembly: Simplifies installation and maintenance with user-friendly assembly and disassembly features.

DALI-2 Compatibility: Supports advanced DALI-2 dimming protocols for enhanced lighting control.

Variety of Lighting Options: Includes single-hole spotlights, linear lights, and decorative lights, offering a wide range of lighting possibilities.

Trim-less Recessed Installation: Provides a clean, seamless look in ceiling installations.

Robust Construction: Features easy electrical connection, a strong base for light modules, and a load-bearing buckle supporting up to 10kg.

Optics Customization: Offers a choice of 23 professional optics, enabling tailored lighting solutions for different applications.

TRACK MODULE ORDERING GUIDE

F-[PG][Model]-[CCT]-[BA]-[DM][IV][IM][TP][LE][CRI]-[Lumens]-[Finish]

EX: F-LNSHWW-1624-27-904515-N48C12B290-1200-B

Product Group (PG)	Model (Model)	CCT (CCT)	Beam Angle (BA)	Dimming (DM)	Input Voltage (IV)	Installation Method (IM)	Typical Power (TP)	Light Engine (LE)	CRI (CRI)	Luminous Flux (Lumens)
LNSHWW Single-Hole Linear Module; Asymmetric Wall Wash Lens	1624 Ø1.57" Housing; 24" Length	27 27K	904515 90°x45°x15° Beam Angle	N Non-Dimming	48 DV48V	C Ceiling Mount	12 12W Power (1624)	B2 Bridgelux 2835	90 90+ CRI	1200 1200 Lumens (1624)
	1635 Ø1.57" Housing; 35" Length	30 30K		V 1-10V Dimming			18 18W Power (1635)			1800 1800 Lumens (1635)
	1647 Ø1.57" Housing; 47" Length	35 35K		D DALI-2			24 24W Power (1647)			2400 2400 Lumens (1647)
		40 40K		T Tuya BT						
				C CASAMBI BT						

DESCRIPTION

Step into the world of FreePoint, where lighting isn't just about seeing, it's about feeling. Our 48V recessed system is more than just a collection of lights – it's a canvas for your imagination. From the sleek elegance of our spotlights to the warm glow of our decorative lights, FreePoint is designed to blend seamlessly into your life, enhancing every space with a touch of sophistication.

Crafting Light, Creating Atmosphere.

SPECIFICATIONS DATA

Installation	Ceiling
Size(s)	0.91" x 0.89" x 24"/35"/47" L
Luminous Flux (lm)	1200 (1624); 1800 (1635); 2400 (1647)
Efficacy	100 LM/W
Finish(es)	Black
Dimming + Control(s)	Non-Dimming; 1-10V; DALI-2; Tuya; CASAMBI
Input Voltage	DC48V
Beam Angle	90° x 45° x 15°
UGR	/
CRI	>90
CCT	27K; 30K; 35K; 40K
Power (W)	12 (1624); 18 (1635); 24 (1647)
Application(s)	Indoor (IP20)

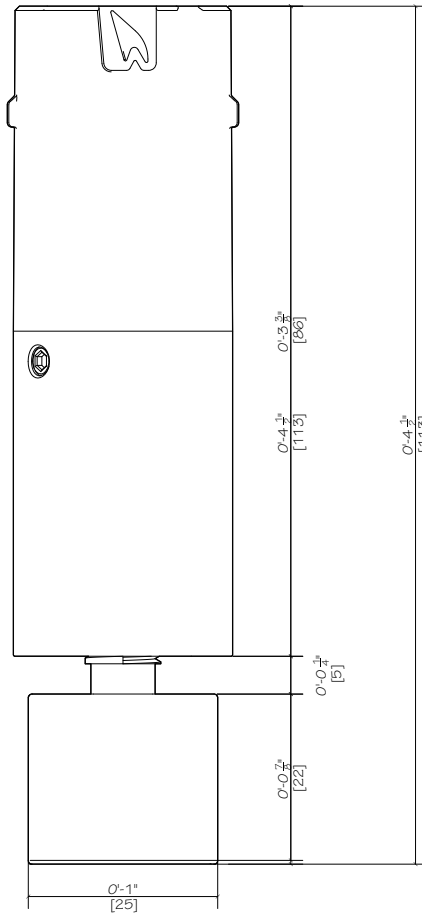

01 FREEPOINT LINEAR MODULE - FRONT ELEVATION
1:1

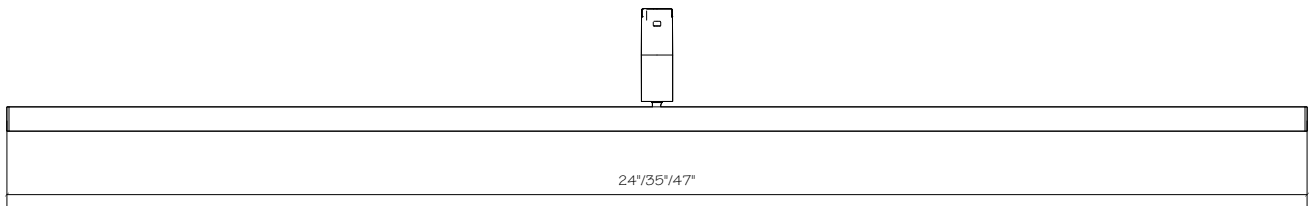

02 FREEPOINT LINEAR MODULE - ELEVATION
1:7



Single-Hole Linear Module (Batwing Distribution Lens)

FREEPOINT™ FEATURES

48V Flexible Recessed System: Offers a flexible and easy-to-integrate solution for various optical modules, enabling product re-use and low-cost light replacement.

Easy Assembly and Disassembly: Simplifies installation and maintenance with user-friendly assembly and disassembly features.

DALI-2 Compatibility: Supports advanced DALI-2 dimming protocols for enhanced lighting control.

Variety of Lighting Options: Includes single-hole spotlights, linear lights, and decorative lights, offering a wide range of lighting possibilities.

Trim-less Recessed Installation: Provides a clean, seamless look in ceiling installations.

Robust Construction: Features easy electrical connection, a strong base for light modules, and a load-bearing buckle supporting up to 10kg.

Optics Customization: Offers a choice of 23 professional optics, enabling tailored lighting solutions for different applications.

TRACK MODULE ORDERING GUIDE

F-[PG][Model]-[CCT]-[BA]-[DM][IV][IM][TP][LE][CRI]-[Lumens]-[Finish]

EX: F-LNSHWW-1624-27-1009015-N48C12B290-1200-B

Product Group (PG)	Model (Model)	CCT (CCT)	Beam Angle (BA)	Dimming (DM)	Input Voltage (IV)	Installation Method (IM)	Typical Power (TP)	Light Engine (LE)	CRI (CRI)	Luminous Flux (Lumens)
LNSHBW Single-Hole Linear Module; Batwing Distribution Lens	1624 Ø1.57" Housing; 24" Length	27 27K	1009015 100°x90°x15° Beam Angle	N Non-Dimming	48 DV48V	C Ceiling Mount	12 12W Power (1624)	B2 Bridgelux 2835	90 90+ CRI	1200 1200 Lumens (1624)
	1635 Ø1.57" Housing; 35" Length	30 30K		V 1-10V Dimming			18 18W Power (1635)			1800 1800 Lumens (1635)
	1647 Ø1.57" Housing; 47" Length	35 35K		D DALI-2			24 24W Power (1647)			2400 2400 Lumens (1647)
		40 40K		T Tuya BT						
				C CASAMBI BT						

DESCRIPTION

Step into the world of FreePoint, where lighting isn't just about seeing, it's about feeling. Our 48V recessed system is more than just a collection of lights – it's a canvas for your imagination. From the sleek elegance of our spotlights to the warm glow of our decorative lights, FreePoint is designed to blend seamlessly into your life, enhancing every space with a touch of sophistication.

Crafting Light, Creating Atmosphere.

SPECIFICATIONS DATA

Installation	Ceiling
Size(s)	0.91" x 0.89" x 24"/35"/47" L
Luminous Flux (lm)	1200 (1624); 1800 (1635); 2400 (1647)
Efficacy	100 LM/W
Finish(es)	Black
Dimming + Control(s)	Non-Dimming; 1-10V; DALI-2; Tuya; CASAMBI
Input Voltage	DC48V
Beam Angle	100° x 90° x 15°
UGR	/
CRI	>90
CCT	27K; 30K; 35K; 40K
Power (W)	12 (1624); 18 (1635); 24 (1647)
Application(s)	Indoor (IP20)

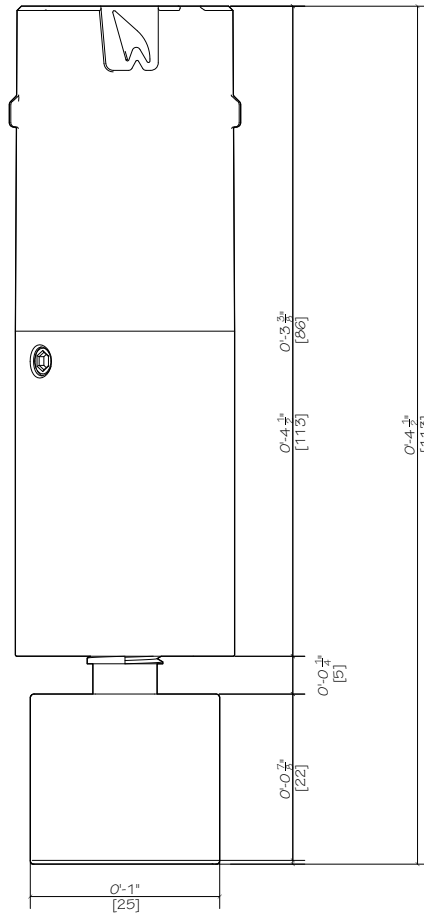

01 FREEPOINT LINEAR MODULE - FRONT ELEVATION
1:1

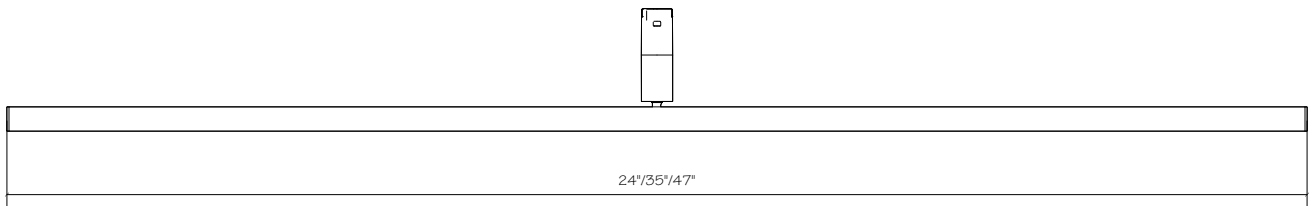

02 FREEPOINT LINEAR MODULE - ELEVATION
1:7

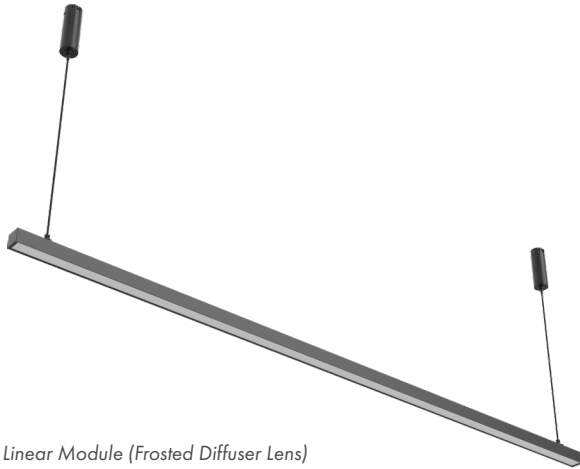

Dual-Hole Linear Module (Frosted Diffuser Lens)

FREEPOINT™ FEATURES

48V Flexible Recessed System: Offers a flexible and easy-to-integrate solution for various optical modules, enabling product re-use and low-cost light replacement.

Easy Assembly and Disassembly: Simplifies installation and maintenance with user-friendly assembly and disassembly features.

DALI-2 Compatibility: Supports advanced DALI-2 dimming protocols for enhanced lighting control.

Variety of Lighting Options: Includes single-hole spotlights, linear lights, and decorative lights, offering a wide range of lighting possibilities.

Trim-less Recessed Installation: Provides a clean, seamless look in ceiling installations.

Robust Construction: Features easy electrical connection, a strong base for light modules, and a load-bearing buckle supporting up to 10kg.

Optics Customization: Offers a choice of 23 professional optics, enabling tailored lighting solutions for different applications.

TRACK MODULE ORDERING GUIDE

F-[PG][Model]-[CCT]-[BA]-[DM][IV][IM][TP][LE][CRI]-[Lumens]-[Finish]

EX: F-LNDHFD-1647-27-110-N48P24B290-1800-B

DESCRIPTION

Step into the world of FreePoint, where lighting isn't just about seeing, it's about feeling. Our 48V recessed system is more than just a collection of lights – it's a canvas for your imagination. From the sleek elegance of our spotlights to the warm glow of our decorative lights, FreePoint is designed to blend seamlessly into your life, enhancing every space with a touch of sophistication.

Crafting Light, Creating Atmosphere.

SPECIFICATIONS DATA

Installation	Pendant
Size(s)	0.91" x 0.89" x 47"/59"/71"/95"
Luminous Flux (lm)	1800 (1647); 2250 (1659); 2700 (1671); 3600 (1695)
Efficacy	75 LM/W
Finish(es)	Black
Dimming + Control(s)	Non-Dimming; 1-10V; DALI-2; Tuya; CASAMBI
Input Voltage	DC48V
Beam Angle	110°
Mounting Height Adjustable	up to 59"
CRI	>90
CCT	27K; 30K; 35K; 40K
Power (W)	24 (1647); 30 (1659); 36 (1671); 48 (1695)
Application(s)	Indoor (IP20)

Product Group (PG)	Model (Model)	CCT (CCT)	Beam Angle (BA)	Dimming (DM)	Input Voltage (IV)	Installation Method (IM)	Typical Power (TP)	Light Engine (LE)	CRI (CRI)	Luminous Flux (Lumens)
LNDHFD Dual-Hole Linear Module; Frosted Diffuser Distribution Lens	1647 Ø1.57" Housing; 47" Length	27 27K	110 110° Beam Angle	N Non-Dimming	48 DV48V	P Pendant Mount	24 24W Power (1647)	B2 Bridgelux 2835	90 90+ CRI	1800 1800 Lumens (1647)
	1659 Ø1.57" Housing; 59" Length	30 30K		V 1-10V Dimming			30 30W Power (1659)			2250 2250 Lumens (1659)
	1671 Ø1.57" Housing; 71" Length	35 35K		D DALI-2			36 36W Power (1671)			2700 2700 Lumens (1671)
	1695 Ø1.57" Housing; 95" Length	40 40K		T Tuya BT			48 48W Power (1695)			3600 3600 Lumens (1695)
				C CASAMBI BT						



FREE™ Series

LINE DRAWING(S)

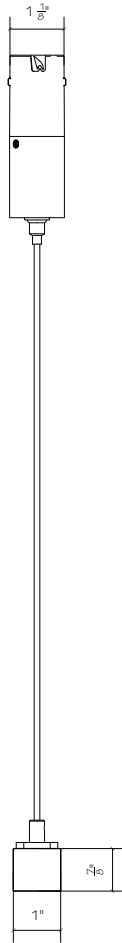

01 FREEPOINT LINEAR MODULE - FRONT ELEVATION
1:4

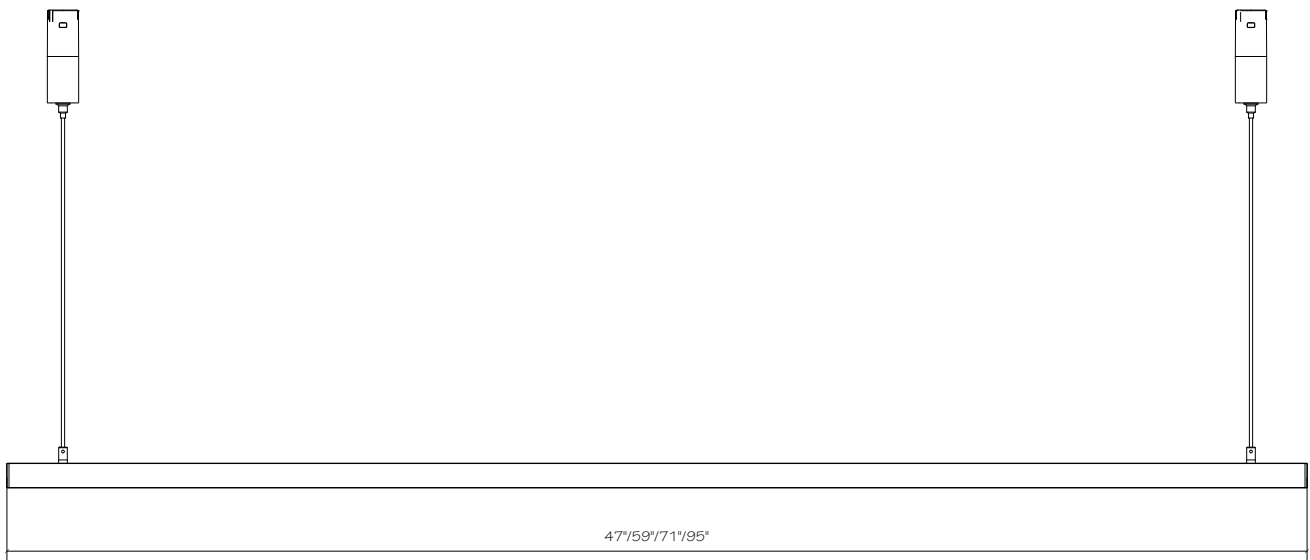

02 FREEPOINT LINEAR MODULE - SIDE ELEVATION
www.epl.com

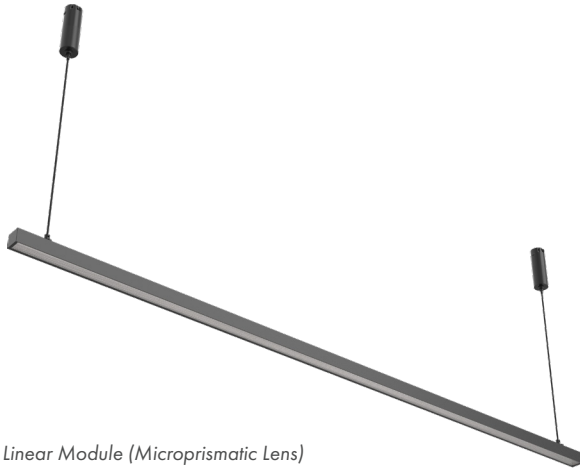

Dual-Hole Linear Module (Microprismatic Lens)

FREEPOINT™ FEATURES

48V Flexible Recessed System: Offers a flexible and easy-to-integrate solution for various optical modules, enabling product re-use and low-cost light replacement.

Easy Assembly and Disassembly: Simplifies installation and maintenance with user-friendly assembly and disassembly features.

DALI-2 Compatibility: Supports advanced DALI-2 dimming protocols for enhanced lighting control.

Variety of Lighting Options: Includes single-hole spotlights, linear lights, and decorative lights, offering a wide range of lighting possibilities.

Trim-less Recessed Installation: Provides a clean, seamless look in ceiling installations.

Robust Construction: Features easy electrical connection, a strong base for light modules, and a load-bearing buckle supporting up to 10kg.

Optics Customization: Offers a choice of 23 professional optics, enabling tailored lighting solutions for different applications.

TRACK MODULE ORDERING GUIDE

F-[PG][Model]-[CCT]-[BA]-[DM][IV][IM][TP][LE][CRI]-[Lumens]-[Finish]

EX: F-LNDHFP-1647-27-70-N48P24B290-1920-B

DESCRIPTION

Step into the world of FreePoint, where lighting isn't just about seeing, it's about feeling. Our 48V recessed system is more than just a collection of lights – it's a canvas for your imagination. From the sleek elegance of our spotlights to the warm glow of our decorative lights, FreePoint is designed to blend seamlessly into your life, enhancing every space with a touch of sophistication.

Crafting Light, Creating Atmosphere.

SPECIFICATIONS DATA

Installation	Pendant
Size(s)	0.91" x 0.89" x 47"/59"/71"/95"
Luminous Flux (lm)	1920 (1647); 2400 (1659); 2880 (1671); 3840 (1695)
Efficacy	80 LM/W
Finish(es)	Black
Dimming + Control(s)	Non-Dimming; 1-10V; DALI-2; Tuya; CASAMBI
Input Voltage	DC48V
Beam Angle	70°
Mounting Height Adjustable	up to 59"
CRI	>90
CCT	27K; 30K; 35K; 40K
Power (W)	24 (1647); 30 (1659); 36 (1671); 48 (1695)
Application(s)	Indoor (IP20)

Product Group (PG)	Model (Model)	CCT (CCT)	Beam Angle (BA)	Dimming (DM)	Input Voltage (IV)	Installation Method (IM)	Typical Power (TP)	Light Engine (LE)	CRI (CRI)	Luminous Flux (Lumens)
LNDHFP Dual-Hole Linear Module; Microprismatic Distribution Lens	1647 Ø1.57" Housing; 47" Length	27 27K	70 70° Beam Angle	N Non-Dimming V 1-10V Dimming D DALI-2 T Tuya BT C CASAMBI BT	48 DV48V	P Pendant Mount	24 24W Power (1647)	B2 Bridgelux 2835	90 90+ CRI	1920 1920 Lumens (1647)
	1659 Ø1.57" Housing; 59" Length	30 30K					30 30W Power (1659)			2400 2400 Lumens (1659)
	1671 Ø1.57" Housing; 71" Length	35 35K					36 36W Power (1671)			2880 2880 Lumens (1671)
	1695 Ø1.57" Housing; 95" Length	40 40K					48 48W Power (1695)			3840 3840 Lumens (1695)



FREE™ Series

LINE DRAWING(S)

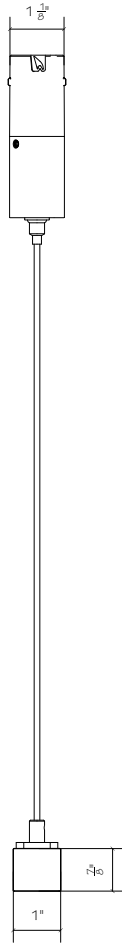

01 FREEPOINT LINEAR MODULE - FRONT ELEVATION
1:4

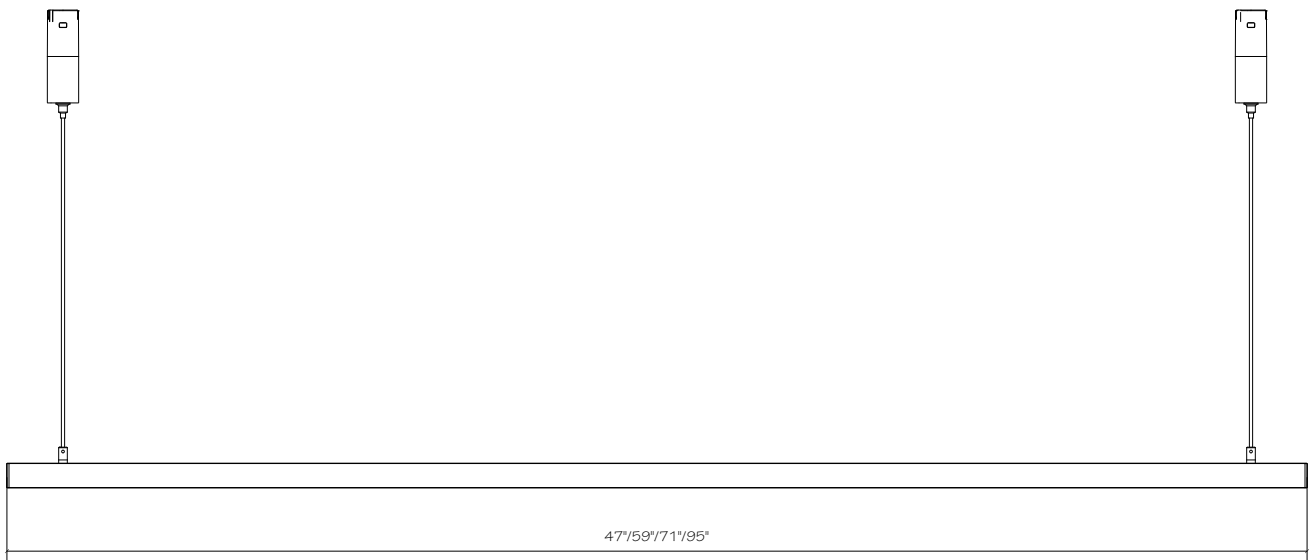

02 FREEPOINT LINEAR MODULE - SIDE ELEVATION
www.epl.com

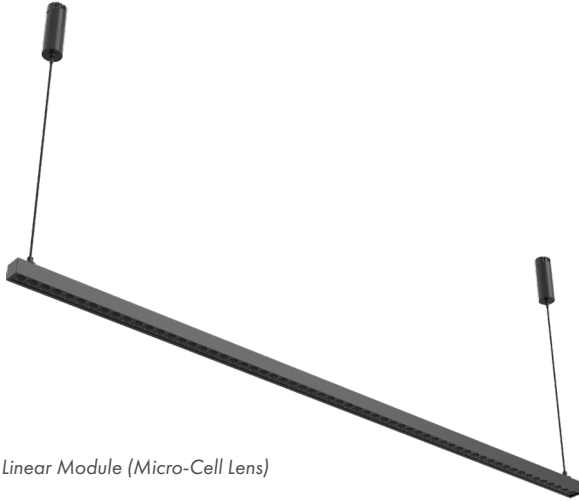

Dual-Hole Linear Module (Micro-Cell Lens)

FREEPOINT™ FEATURES

48V Flexible Recessed System: Offers a flexible and easy-to-integrate solution for various optical modules, enabling product re-use and low-cost light replacement.

Easy Assembly and Disassembly: Simplifies installation and maintenance with user-friendly assembly and disassembly features.

DALI-2 Compatibility: Supports advanced DALI-2 dimming protocols for enhanced lighting control.

Variety of Lighting Options: Includes single-hole spotlights, linear lights, and decorative lights, offering a wide range of lighting possibilities.

Trim-less Recessed Installation: Provides a clean, seamless look in ceiling installations.

Robust Construction: Features easy electrical connection, a strong base for light modules, and a load-bearing buckle supporting up to 10kg.

Optics Customization: Offers a choice of 23 professional optics, enabling tailored lighting solutions for different applications.

TRACK MODULE ORDERING GUIDE

F-[PG][Model]-[CCT]-[BA]-[DM][IV][IM][TP][LE][CRI]-[Lumens]-[Finish]

EX: F-LNDHMC-1651-27-30-N48P26O290-1820-B

Product Group (PG)	Model (Model)	CCT (CCT)	Beam Angle (BA)	Dimming (DM)	Input Voltage (IV)	Installation Method (IM)	Typical Power (TP)	Light Engine (LE)	CRI (CRI)	Luminous Flux (Lumens)
LNDHMC Dual-Hole Linear Module; Microcell Distribution Lens	1651 Ø1.57" Housing; 51" Length	27 27K	30 30° Beam Angle	N Non-Dimming	48 DV48V	P Pendant Mount	26 26W Power (1651)	O2 OSRAM 2835	90 90+ CRI	1820 1820 Lumens (1651)
	1677 Ø1.57" Housing; 77" Length	30 30K	55 55° Beam Angle	V 1-10V Dimming			39 39W Power (1677)			2730 2730 Lumens (1677)
		35 35K		D DALI-2						
		40 40K		T Tuya BT						
				C CASAMBI BT						

DESCRIPTION

Step into the world of FreePoint, where lighting isn't just about seeing, it's about feeling. Our 48V recessed system is more than just a collection of lights – it's a canvas for your imagination. From the sleek elegance of our spotlights to the warm glow of our decorative lights, FreePoint is designed to blend seamlessly into your life, enhancing every space with a touch of sophistication.

Crafting Light, Creating Atmosphere.

SPECIFICATIONS DATA

Installation	Pendant
Size(s)	0.91" x 0.89" x 51"/ 77"
Luminous Flux (lm)	1820 (1651); 2730 (1677)
Efficacy	70 LM/W
Finish(es)	Black
Dimming + Control(s)	Non-Dimming; 1-10V; DALI-2; Tuya; CASAMBI
Input Voltage	DC48V
Beam Angle	30° / 55°
Mounting Height Adjustable	up to 59"
CRI	>90
CCT	27K; 30K; 35K; 40K
Power (W)	26 (1651); 39 (1677)
Application(s)	Indoor (IP20)



FREE™ Series

LINE DRAWING(S)

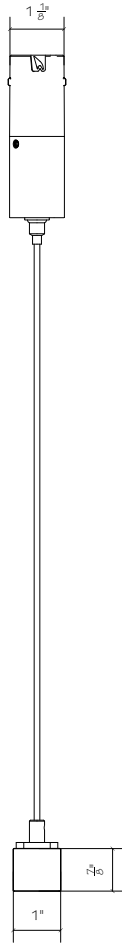

01 FREEPOINT LINEAR MODULE - FRONT ELEVATION
1:4



02 FREEPOINT LINEAR MODULE - SIDE ELEVATION
www.epl.com

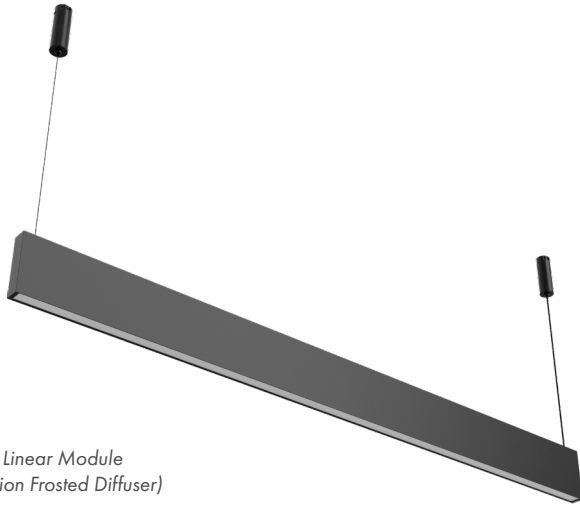

Dual-Hole Linear Module
(Combination Frosted Diffuser)

FREEPOINT™ FEATURES

48V Flexible Recessed System: Offers a flexible and easy-to-integrate solution for various optical modules, enabling product re-use and low-cost light replacement.

Easy Assembly and Disassembly: Simplifies installation and maintenance with user-friendly assembly and disassembly features.

DALI-2 Compatibility: Supports advanced DALI-2 dimming protocols for enhanced lighting control.

Variety of Lighting Options: Includes single-hole spotlights, linear lights, and decorative lights, offering a wide range of lighting possibilities.

Trim-less Recessed Installation: Provides a clean, seamless look in ceiling installations.

Robust Construction: Features easy electrical connection, a strong base for light modules, and a load-bearing buckle supporting up to 10kg.

Optics Customization: Offers a choice of 23 professional optics, enabling tailored lighting solutions for different applications.

TRACK MODULE ORDERING GUIDE

F-[PG][Model]-[CCT]-[BA]-[DM][IV][IM][TP][LE][CRI]-[Lumens]-[Finish]

EX: F-LNCDHFD-1648-27-110-N48P48B290-2880-B

DESCRIPTION

Step into the world of FreePoint, where lighting isn't just about seeing, it's about feeling. Our 48V recessed system is more than just a collection of lights – it's a canvas for your imagination. From the sleek elegance of our spotlights to the warm glow of our decorative lights, FreePoint is designed to blend seamlessly into your life, enhancing every space with a touch of sophistication.

Crafting Light, Creating Atmosphere.

SPECIFICATIONS DATA

Installation	Pendant
Size(s)	1" x 3.94" x 48"/59"/71"/95"
Luminous Flux (lm)	2880 (1648); 3600 (1659); 4320 (1671); 5760 (1695)
Efficacy	60 LM/W
Finish(es)	Black
Dimming + Control(s)	Non-Dimming; 1-10V; DALI-2; Tuya; CASAMBI
Input Voltage	DC48V
Beam Angle	110°
Mounting Height Adjustable	up to 59"
CRI	>90
CCT	27K; 30K; 35K; 40K
Power (W)	48 (1648); 60 (1659); 72 (1671); 96 (1695)
Application(s)	Indoor (IP20)

Product Group (PG)	Model (Model)	CCT (CCT)	Beam Angle (BA)	Dimming (DM)	Input Voltage (IV)	Installation Method (IM)	Typical Power (TP)	Light Engine (LE)	CRI (CRI)	Luminous Flux (Lumens)
LNCDHFD Dual-Hole Linear Combination Module; Frosted Diffuser Distribution Lens	1648 Ø1.57" Housing; 48" Length	27 27K 30 30K	110 110° Beam Angle	N Non-Dimming	48 DV48V	P Pendant Mount	48 48W Power (1648)	B2 Bridgelux 2835	90 90+ CRI	2880 2880 Lumens (1648)
	1659 Ø1.57" Housing; 59" Length	35 35K		V 1-10V Dimming			60 60W Power (1659)			3600 3600 Lumens (1659)
	1671 Ø1.57" Housing; 71" Length	40 40K		D DALI-2			72 72W Power (1671)			4320 4320 Lumens (1671)
	1695 Ø1.57" Housing; 95" Length	40K		T Tuya BT			96 96W Power (1695)			5760 5760 Lumens (1695)
				C CASAMBI BT						



FREE™ Series

LINE DRAWING(S)

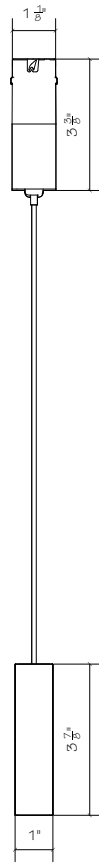

01 FREEPOINT LINEAR MODULE - FRONT ELEVATION
1:4



02 FREEPOINT LINEAR MODULE - SIDE ELEVATION
www.epl.com

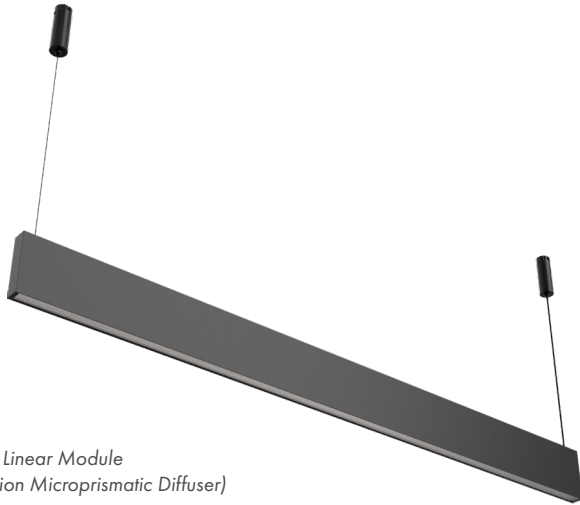

Dual-Hole Linear Module
(Combination Microprismatic Diffuser)

FREEPOINT™ FEATURES

48V Flexible Recessed System: Offers a flexible and easy-to-integrate solution for various optical modules, enabling product re-use and low-cost light replacement.

Easy Assembly and Disassembly: Simplifies installation and maintenance with user-friendly assembly and disassembly features.

DALI-2 Compatibility: Supports advanced DALI-2 dimming protocols for enhanced lighting control.

Variety of Lighting Options: Includes single-hole spotlights, linear lights, and decorative lights, offering a wide range of lighting possibilities.

Trim-less Recessed Installation: Provides a clean, seamless look in ceiling installations.

Robust Construction: Features easy electrical connection, a strong base for light modules, and a load-bearing buckle supporting up to 10kg.

Optics Customization: Offers a choice of 23 professional optics, enabling tailored lighting solutions for different applications.

TRACK MODULE ORDERING GUIDE

F-[PG][Model]-[CCT]-[BA]-[DM][IV][IM][TP][LE][CRI]-[Lumens]-[Finish]

EX: F-LNCDHFP-1648-27-70-N48P48B290-2976-B

DESCRIPTION

Step into the world of FreePoint, where lighting isn't just about seeing, it's about feeling. Our 48V recessed system is more than just a collection of lights – it's a canvas for your imagination. From the sleek elegance of our spotlights to the warm glow of our decorative lights, FreePoint is designed to blend seamlessly into your life, enhancing every space with a touch of sophistication.

Crafting Light, Creating Atmosphere.

SPECIFICATIONS DATA

Installation	Pendant
Size(s)	1" x 3.94" x 48"/59"/71"/95"
Luminous Flux (lm)	2976 (1648); 3720 (1659); 4464 (1671); 5952 (1695)
Efficacy	62 LM/W
Finish(es)	Black
Dimming + Control(s)	Non-Dimming; 1-10V; DALI-2; Tuya; CASAMBI
Input Voltage	DC48V
Beam Angle	70°
Mounting Height Adjustable	up to 59"
CRI	>90
CCT	27K; 30K; 35K; 40K
Power (W)	48 (1648); 60 (1659); 72 (1671); 96 (1695)
Application(s)	Indoor (IP20)

Product Group (PG)	Model (Model)	CCT (CCT)	Beam Angle (BA)	Dimming (DM)	Input Voltage (IV)	Installation Method (IM)	Typical Power (TP)	Light Engine (LE)	CRI (CRI)	Luminous Flux (Lumens)
LNCDHFP Dual-Hole Linear Combination Module; Microprismatic Distribution Lens	1648 Ø1.57" Housing; 48" Length	27 27K 30 30K	70 70° Beam Angle	N Non-Dimming	48 DV48V	P Pendant Mount	48 48W Power (1648)	B2 Bridgelux 2835	90 90+ CRI	2976 2976 Lumens (1648)
	1659 Ø1.57" Housing; 59" Length	35 35K		V 1-10V Dimming			60 60W Power (1659)			3720 3720 Lumens (1659)
	1671 Ø1.57" Housing; 71" Length	40 40K		D DALI-2			72 72W Power (1671)			4464 4464 Lumens (1671)
	1695 Ø1.57" Housing; 95" Length			T Tuya BT			96 96W Power (1695)			5952 5952 Lumens (1695)
				C CASAMBI BT						



FREE™ Series

LINE DRAWING(S)

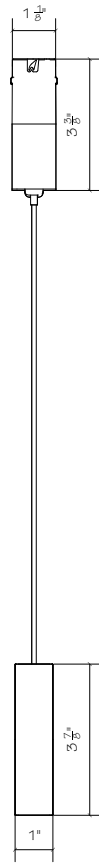

01 FREEPOINT LINEAR MODULE - FRONT ELEVATION
1:4



02 FREEPOINT LINEAR MODULE - SIDE ELEVATION
www.epl.com

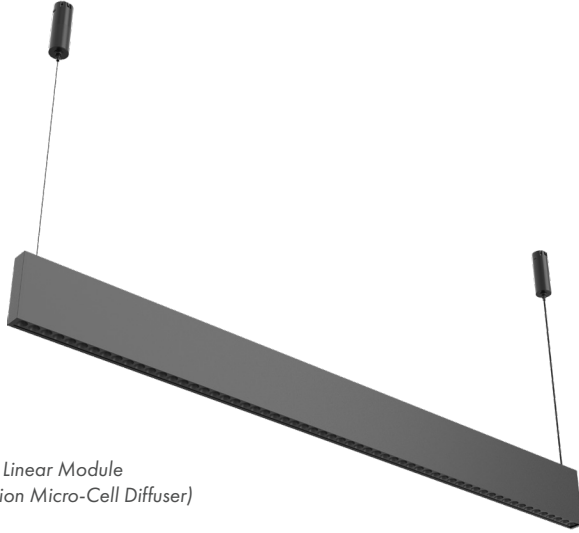

Dual-Hole Linear Module
(Combination Micro-Cell Diffuser)

FREEPOINT™ FEATURES

48V Flexible Recessed System: Offers a flexible and easy-to-integrate solution for various optical modules, enabling product re-use and low-cost light replacement.

Easy Assembly and Disassembly: Simplifies installation and maintenance with user-friendly assembly and disassembly features.

DALI-2 Compatibility: Supports advanced DALI-2 dimming protocols for enhanced lighting control.

Variety of Lighting Options: Includes single-hole spotlights, linear lights, and decorative lights, offering a wide range of lighting possibilities.

Trim-less Recessed Installation: Provides a clean, seamless look in ceiling installations.

Robust Construction: Features easy electrical connection, a strong base for light modules, and a load-bearing buckle supporting up to 10kg.

Optics Customization: Offers a choice of 23 professional optics, enabling tailored lighting solutions for different applications.

TRACK MODULE ORDERING GUIDE

F-[PG][Model]-[CCT]-[BA]-[DM][IV][IM][TP][LE][CRI]-[Lumens]-[Finish]

EX: F-LNCDHMC-1651-27-30-N48P53O290-2862-B

DESCRIPTION

Step into the world of FreePoint, where lighting isn't just about seeing, it's about feeling. Our 48V recessed system is more than just a collection of lights – it's a canvas for your imagination. From the sleek elegance of our spotlights to the warm glow of our decorative lights, FreePoint is designed to blend seamlessly into your life, enhancing every space with a touch of sophistication.

Crafting Light, Creating Atmosphere.

SPECIFICATIONS DATA

Installation	Pendant
Size(s)	1" x 3.94" x 51"/ 77" L
Luminous Flux (lm)	2862 (1651); 4212 (1677)
Efficacy	54 LM/W
Finish(es)	Black
Dimming + Control(s)	Non-Dimming; 1-10V; DALI-2; Tuya; CASAMBI
Input Voltage	DC48V
Beam Angle	30°/55°
Mounting Height Adjustable	up to 59"
CRI	>90
CCT	27K; 30K; 35K; 40K
Power (W)	53 (1651); 78 (1677)
Application(s)	Indoor (IP20)

Product Group (PG)	Model (Model)	CCT (CCT)	Beam Angle (BA)	Dimming (DM)	Input Voltage (IV)	Installation Method (IM)	Typical Power (TP)	Light Engine (LE)	CRI (CRI)	Luminous Flux (Lumens)
LNCDHMC Dual-Hole Linear Combination Module; Micro-Cell Distribution Lens	1651 Ø1.57" Housing; 51" Length	27 27K	30 30° Beam Angle	N Non-Dimming	48 DV48V	P Pendant Mount	53 53W Power (1651)	O2 OSRAM 2835	90 90+ CRI	2862 2862 Lumens (1651)
		30 30K	55 55° Beam Angle	V 1-10V Dimming			78 78W Power (1677)			4212 4212 Lumens (1677)
	1677 Ø1.57" Housing; 77" Length	35 35K		D DALI-2						
		40 40K		T Tuya BT						
				C CASAMBI BT						



FREE™ Series

LINE DRAWING(S)

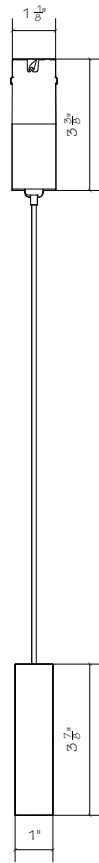

01 FREEPOINT LINEAR MODULE - FRONT ELEVATION
1:4



02 FREEPOINT LINEAR MODULE - SIDE ELEVATION
www.epl.com

RA-HR40 — BASE MODULE



Material	PC+ADC12
Finish	Black
Aperture Size	Ø42mm
Input Voltage	DC48V
Rated Power	150W
Rated Current	3A

TB-02 — QUICK CONNECTOR

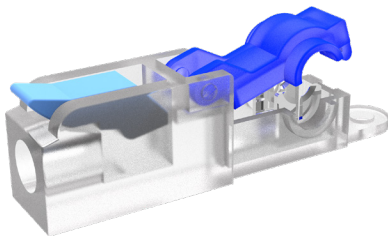

Material	PA6
Size	L38xW9.4xH10.5mm
Acceptable Wiring	0.5-4MM ² (Solid Wire); 0.5-2.5MM ² (Stranded Wire)
Rated Voltage	250V/600V
Rated Current	32A

CV-HR40 — RECESSED COVER

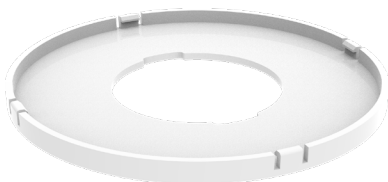

Material	PC+ADC12
Finish	Black
Aperture Size	Ø42mm
Input Voltage	DC48V
Rated Power	150W
Rated Current	3A

SKETCH YOUR OWN CONFIGURATION (for reference only — no one's expecting Picasso)

