

INFINITY

SCULPTURE IN LIGHT

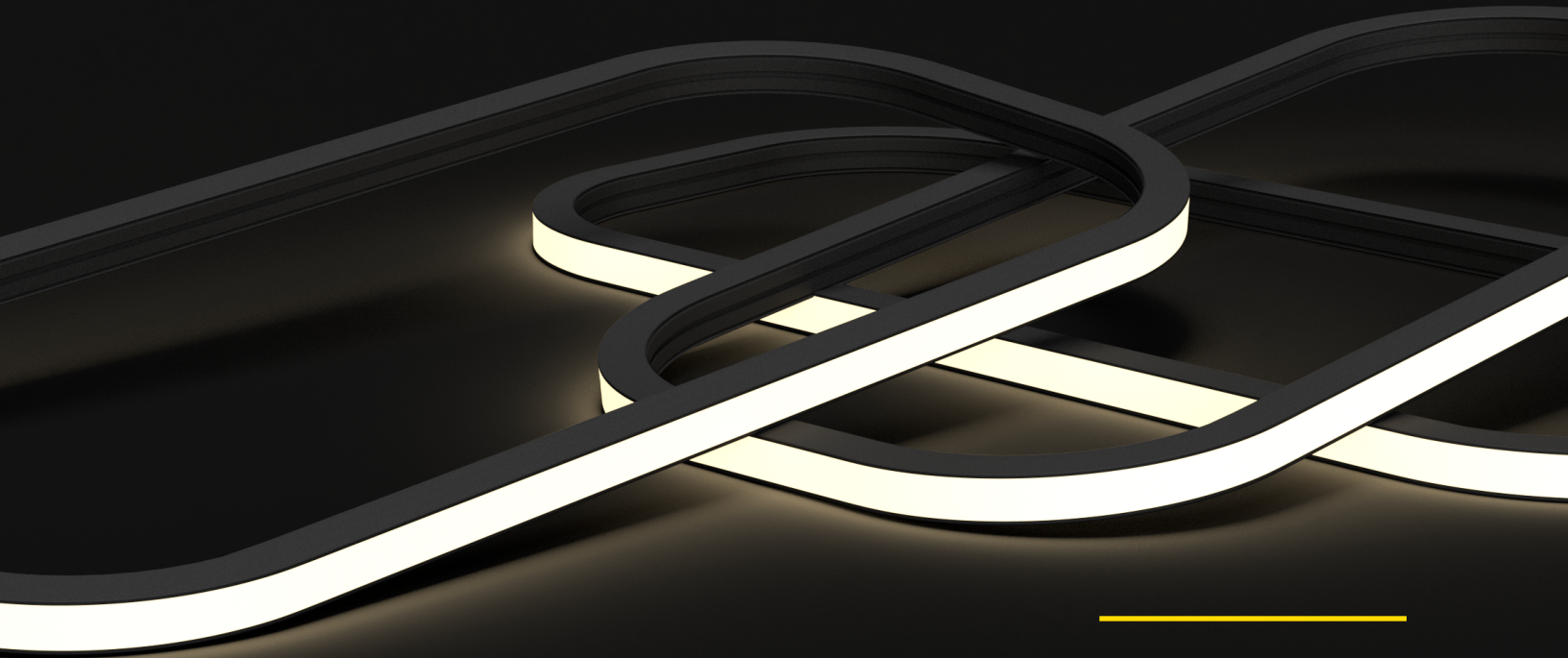

LIT DESIGN AWARDS 2023
Designer/Custom Lighting
LFI 2021 WINNER
Design Excellence Award



SCULPTURE IN LIGHT.

Infinity is the first linear/curved lighting system that can bend light freely on a multi-dimensional plane. In one configuration, sculpt any shape while combining rigid linear, curved, and twisted modules. Each module is available in multiple light source directions, enabling vertical, horizontal, and multi-directional light—for a 2D/3D luminaire that doubles as an architectural element in addition to a unique ambient light source.

LIT DESIGN AWARDS 2023
DESIGNER / CUSTOM LIGHTING

LFI 2021
LIGHTFAIR INNOVATION AWARD
DESIGN EXCELLENCE

FEATURES

Versatile Modular Design.

Our lighting system allows for unparalleled creativity, enabling the assembly of unique designs such as arcs, infinity loops, double helices, and more. Tailor your lighting to fit any space or architectural feature, crafting continuous forms that flow seamlessly from ceiling to wall.

Adaptive Illumination.

Experience uninterrupted lighting that effortlessly wraps around beams, tucks into narrow spaces, and extends beyond traditional boundaries. Our system's flexibility transforms lighting into an art form, ensuring every corner is gracefully illuminated.

Innovative 'Shape-Shifting' Lens.

Equipped with a flexible lens, our lighting provides continuous, diffuse light across extensive runs. Choose from two distinct designs to match your aesthetic needs, each promising a smooth and consistent lighting experience.

Durable and Resilient Build.

Constructed from corrosion-resistant, heat-treated aluminum 6063-T5, our lights are built to last. The surface is treated with a specialized spray to enhance durability, ensuring long-lasting quality and performance.

Uniform LED Illumination.

Our integrated optical LED board design spans the entire length of the fixture, offering end-to-end, uniform illumination. This feature guarantees a consistent and visually pleasing light output, enhancing any space it adorns.

Dynamic RGB Lighting.

Elevate your environment with the added dimension of RGB lighting capabilities. Our system offers a spectrum of vibrant colors, allowing you to set the mood, match a theme, or create dynamic lighting effects that captivate and inspire.

SPECS

LUMENS	up to 370 lm/ft
EFFICACY	up to 72 lm/W
CCT	19K-60K, RGB
CRI	90+ Standard
MOUNTING	Pendant (P); Surface (S)
CRI	90+
LIGHTING MODULES	Direct; Indirect; Inwards; Outwards
SIZE	1.5" x 1.5" (Standard) (2" x 2.5" upon request)
FINISH	Black; White; Silver; Custom RAL
DIMMING & CONTROLS	Flicker-Free 1% Dimming - 120 or 277V (DIM10), Hi-Lume 1% 2-Wire 120V only (LTEA2W), Hi-Lume 0.1% EcoSystem w/Soft- on, Fade-to-Black (HI- LUME). DT6, DT8 dimming down to 0.1% (DALI), DMX 'Dim-to-Dark' (ELDOD- MX.1). Consult factory for emergency.

INFINITY's mounting options enable varied installations in one setup, offering straightforward, adaptable solutions.

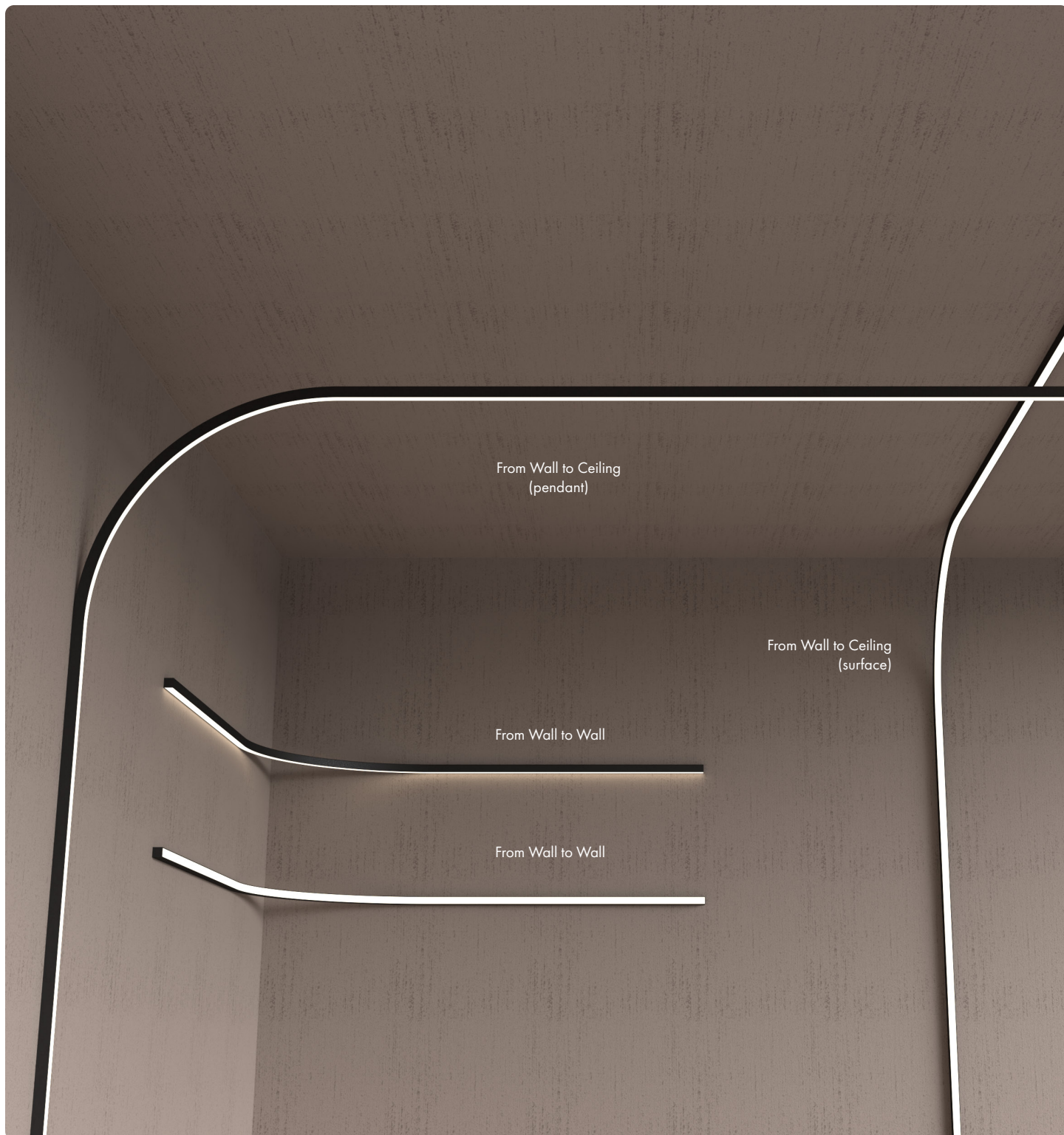

INFINITY's diverse mounting choices allow for multiple installation options within a single system, ensuring flexibility and ease.

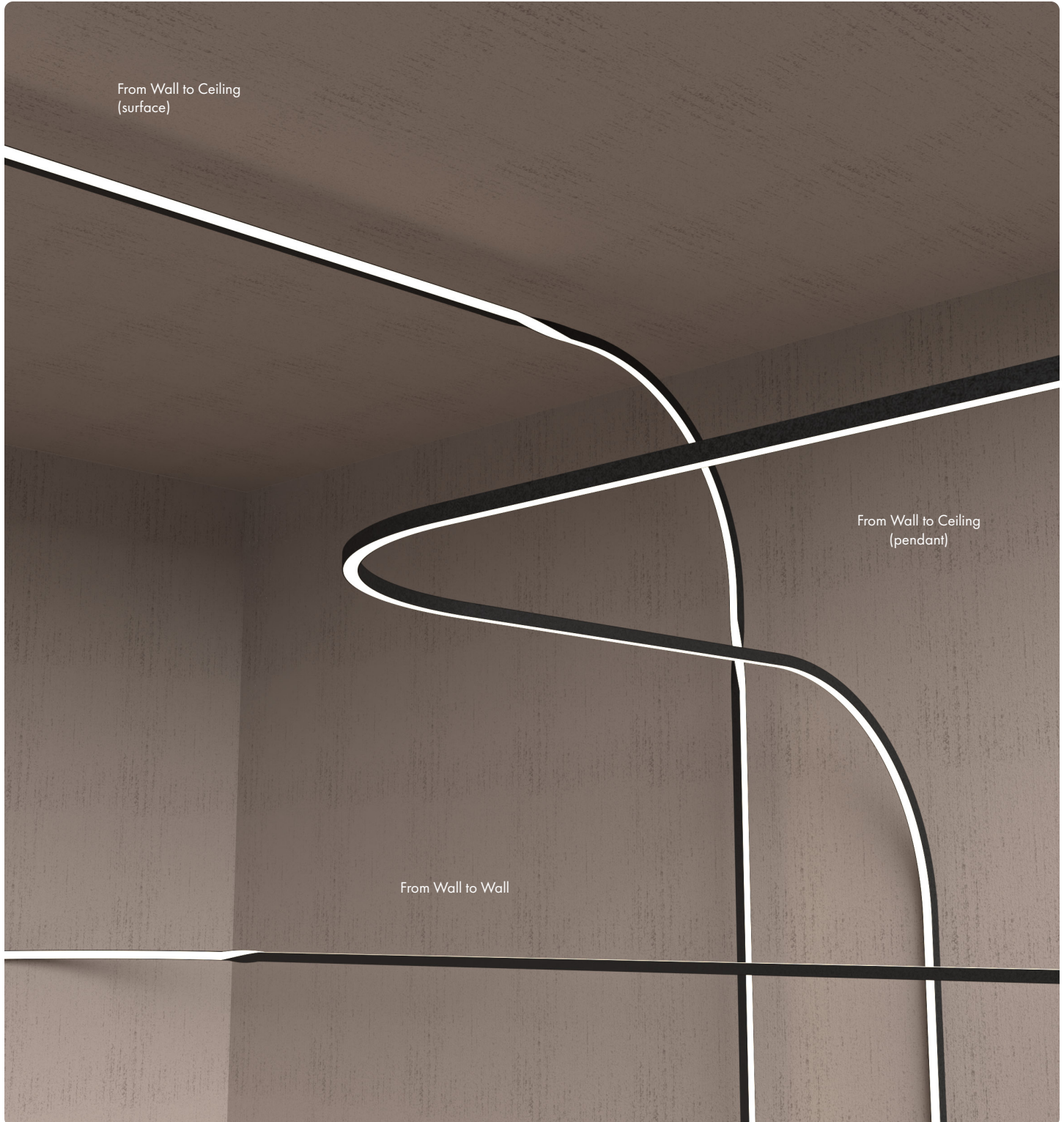

S Shapes

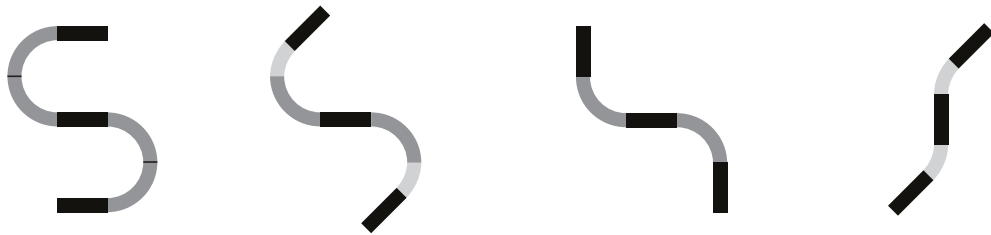

L Shapes



O Shapes



U Shapes



Straight run w/ minimum length of 12"
Maximum length of 98"
Sections can be cut in factory every 2"

90° arc available in nominal 1', 3',
and 5' diameters

45° arc available
in all nominal sizes





HORIZON.



SUNSET.

**Actual
Diameters**

D1 - 12½"
D2 - 31½"
D3 - 59"
D4 - 118"

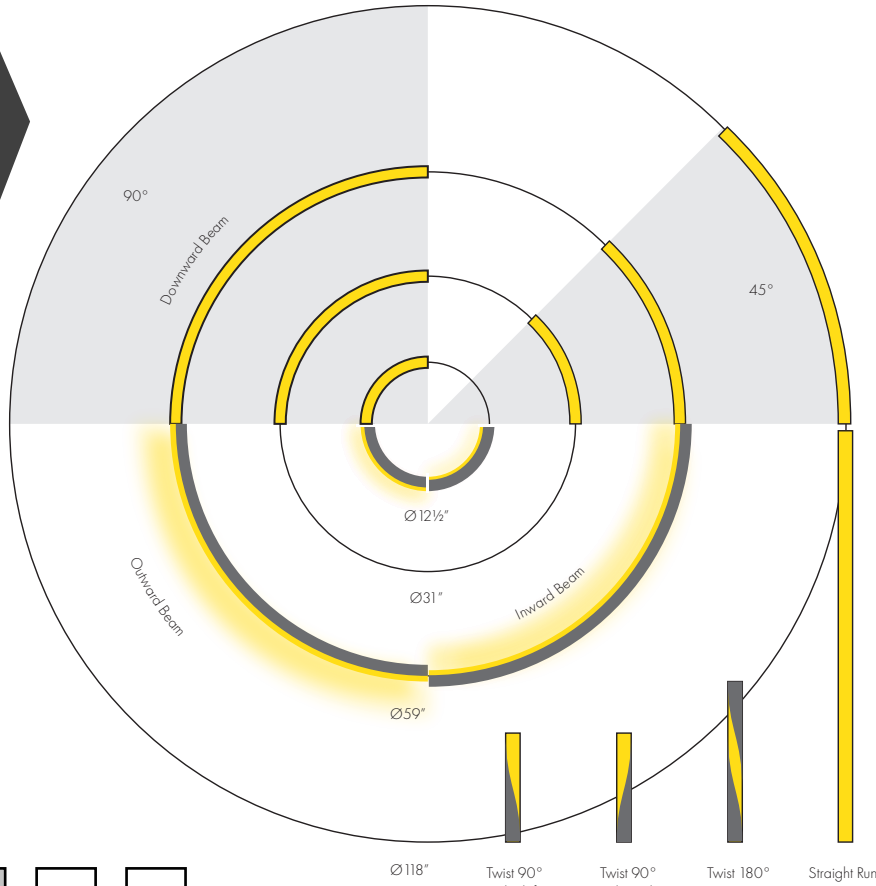

Finish

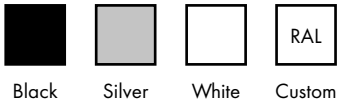

Arc Dimensions

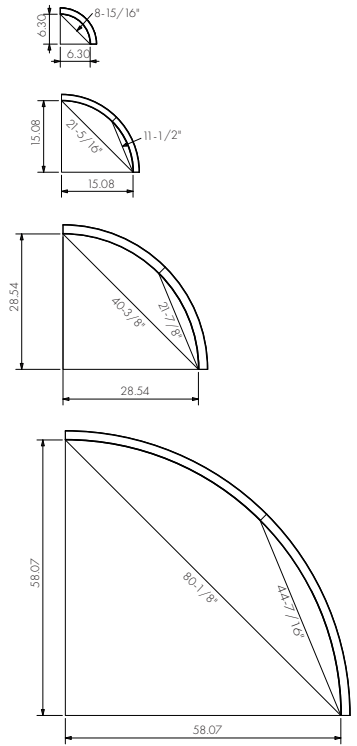

Profile Options

Curves/Rings

INF1 SERIES

	45°			90°		
	Downlight	Inward	Outward	Downlight	Inward	Outward
Ø 12½"				✓	✓	✓
Ø 31½"	✓			✓		
Ø 59"	✓			✓	✓	✓
Ø 118"	✓					

Suspended Mount
Horizontal



Downward Beam
(DB)



Outward Beam
(OB)



Inward Beam
(IB)

Suspended Mount
Vertical



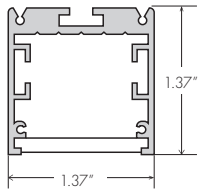

INF1 SERIES

Nominal Diameter

1'

Lighting Downward



Nominal Diameter

3'

Lighting Downward

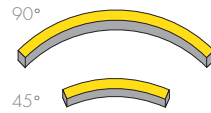

Nominal Diameter

5'

Lighting Downward

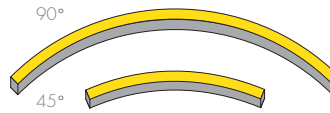

Lighting Inward



Lighting Outward



Nominal Diameter

10'

Lighting Downward



Straight Modules



Straight Run

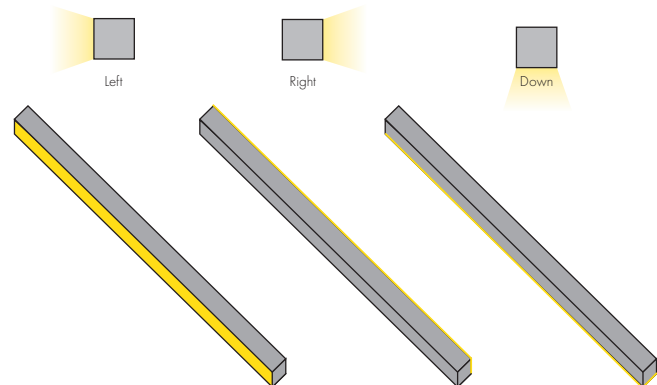

- Straight modules can be cut every 2"
- Flexible LED board comes in 16ft 5in (5m) rolls; Sections can be cut every 2"
- Extrusions and LEDs cut and installed in our factory

Straight to Twist Connections

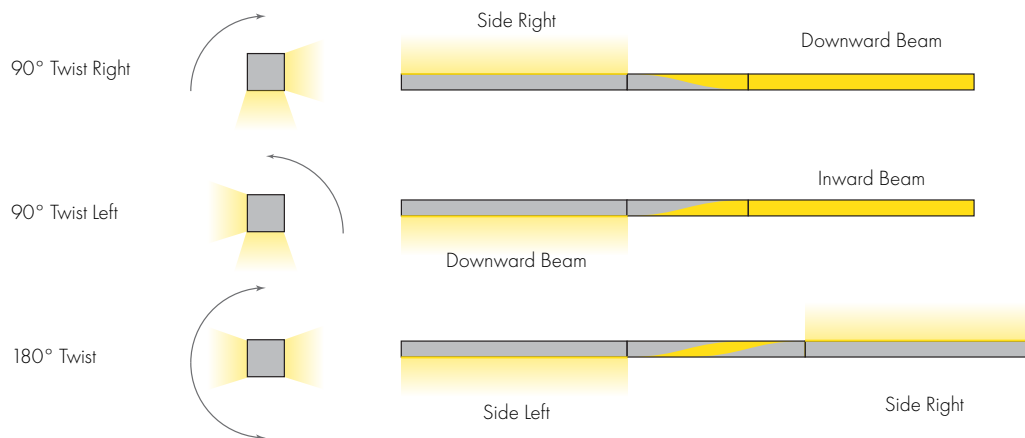

Quadrilateral Pendant Solution

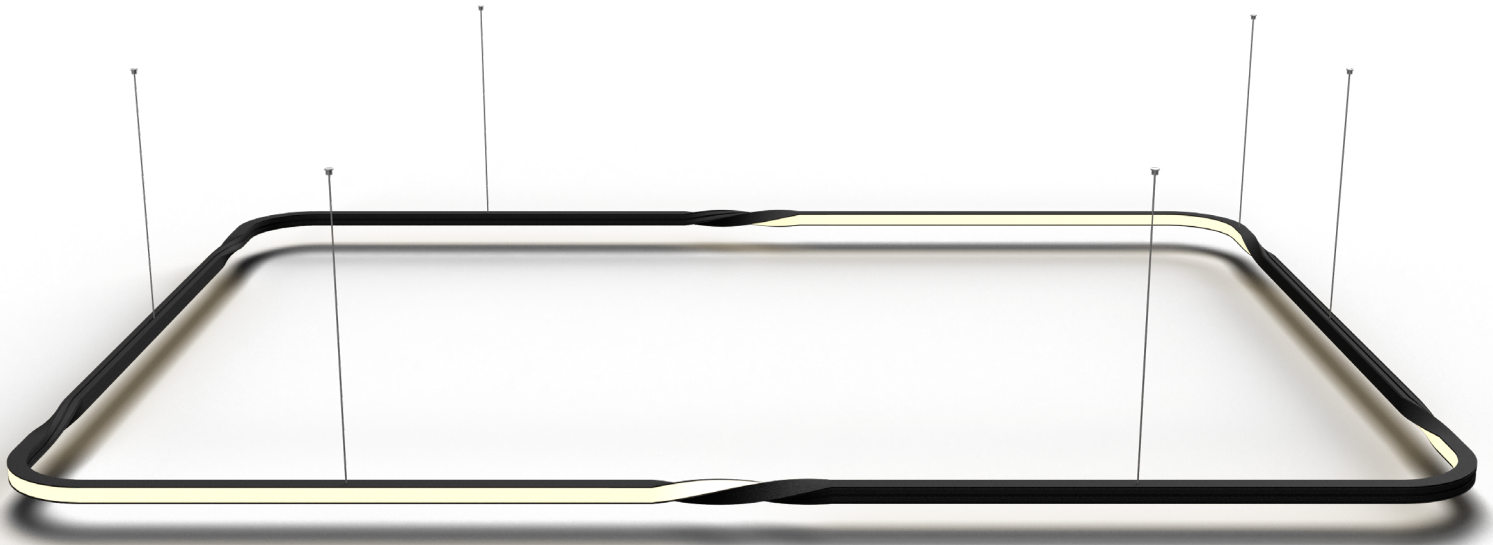

Connecting Multi-Directional Beams of Light

To configure a single luminaire design with multiple light source directions, a twist module is needed to connect the differing light source directions (inward and outward modules).

Example: Use two 90° twist and two 180° twist modules to connect straight and curved modules, to create a quadrilateral shape emitting light in multiple directions.

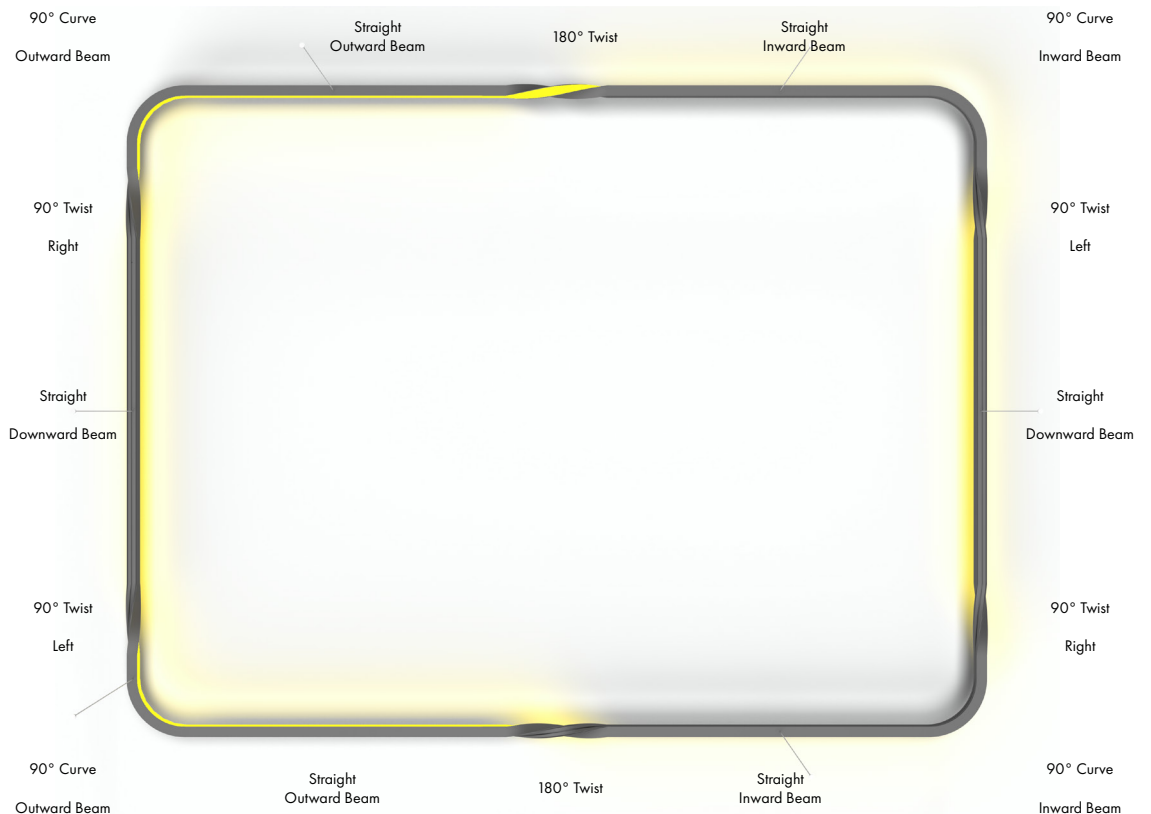



SERPENTINE.









EXAMPLE: (APPLICATION DESIGN & ENGINEERING PROVIDED FOR EVERY JOB)

INF1-LED-48FT-EDISONSHOWROOM-0620-P-500L-DIM10-DB-24V-35K-90-SI

SERIES	LINEAR TOTAL*	PROJECT NAME	DRAWING NO.*	MOUNT	LUMENS	BEAM DIRECTION	INPUT VOLTAGE	CCT	CRI	FINISH
INF1-LED	Measure of total linear feet * Will be determined by application engineer and confirmed by specifier	PROJECT NAME (abbrev.)	Drawing number will be provided upon issue of quote	P Pendant S Surface	500L 500 lumens per foot	DB Downward; Direct OB Outward IB Inward	24V Low voltage	27K 2700K 30K 3000K 35K 3500K 40K 4000K 50K 5000K RGB RGB Lighting	90	BK Black SI Silver WH White RAL Custom RAL
<div></div> <div>DRIVER OPTIONS</div>										

DIM10
1-10V Dimming

LTEA2W
Hi-lume 1% 2-Wire 120V Forward-Phase Control; 120V only; max 40W per driver

HI-LUME
Hi-lume 0.1% EcoSystem w/Soft-on, Fade-to-Black; 120V or 277V; max 90W per driver

NONDIM
120V or 277V; max 90W for each driver

ELDODALI
DT6, DT8 dimming down to 0.1%

SKETCH YOUR OWN CONFIGURATION (for reference only — no one's expecting Picasso)

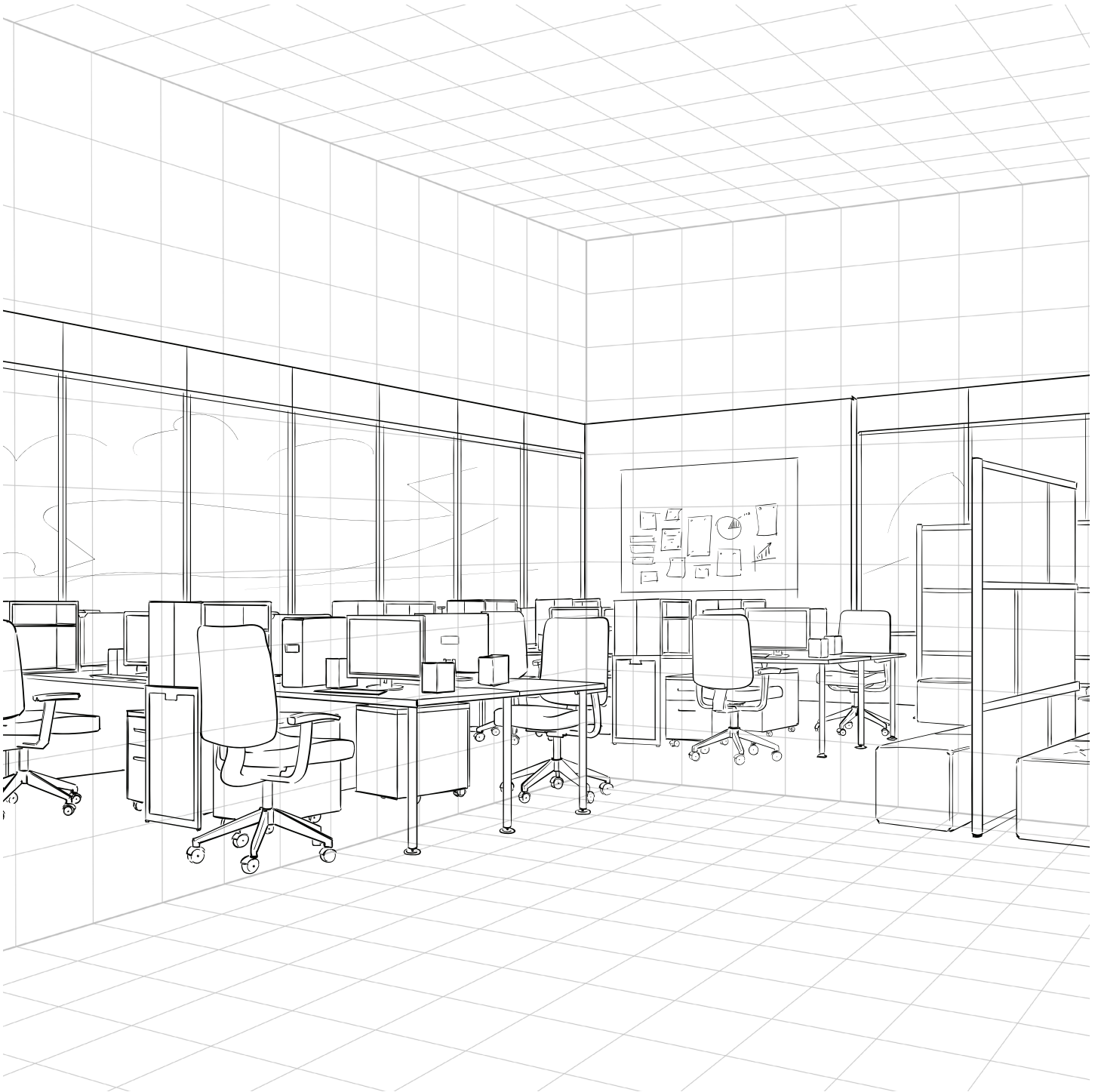



GATEWAY.



