



SALIOT

Lighting Innovation MS-V5A smart motorized track mounted LED accent light



SALIOT MS-V5A is a CCT tunable mesh network enabled motorized LED track luminaire.

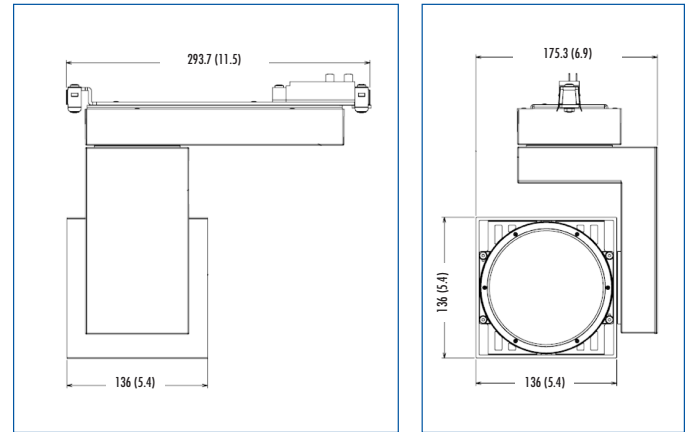

Complete dimensions and clearance details provided below

FEATURES

- **SALIOT MS-V5A delivers light output ranging from 3010 lumens to 3600 lumens.**
- **SALIOT is wirelessly controlled from as far as 60 feet by Bluetooth** via a smart device with the SALIOT iOS or android App.
- **SALIOT app controls the luminaire's motors and LED module** to adjust the following features:
 - correlated color temperature (CCT) of 2700K to 5000K,
 - 14° to 38° beamspread (zoom),
 - 360° horizontal rotation (pan),
 - 90° vertical adjustment (tilt),
 - on/off switching, and
 - dimming from 100% to 1%.
- **As many as 100 SALIOT MS-V5s may be grouped** and settings can be saved as scenes.
- **SALIOT MS-V5A luminaires are manufactured by MinebeaMitsumi and equipped by Edison Price Lighting** with track adapters permitting their use on 120-volt, 20-amp Edison Price Lighting track systems.
- **For more information, [click here](#).**

APPLICATIONS

Luminaire is  certified for use on horizontally-mounted Edison Price Lighting 120-volt, 20 amp track. Not suitable for use on vertically-mounted track. Not suitable for use in a Unicep single-fixture track receptacle. Not suitable for use on electrical circuits including dimming controls of any kind.

Mounting on outlet-box, Eutrac, or Global track system also available.
Contact Edison Price Lighting.

PRODUCT CODE

For complete product code, list basic unit and select one item from each following box.

Basic Unit SLT-5A

LED Detail (CRI/CCT/luminaire output at 30° beam spread)

83 CRI KS

Finish

white - WH
black - BL

Dimming Notes:

- Luminaire is suitable for use only on an electrical circuit which does not include a dimming device of any kind.
- Luminaire may be dimmed only by Bluetooth via a smart device with the SALIOT iOS or Android App.

Warranty Details:

Fixture covered by MinebeaMitsumi warranty; track adapter covered by Edison Price Lighting warranty.



MinebeaMitsumi
Passion to Create Value through Difference



SALIOT

Lighting Innovation MS-V5A smart motorized track mounted LED accent light

EDISON PRICE
LIGHTING

Clearance

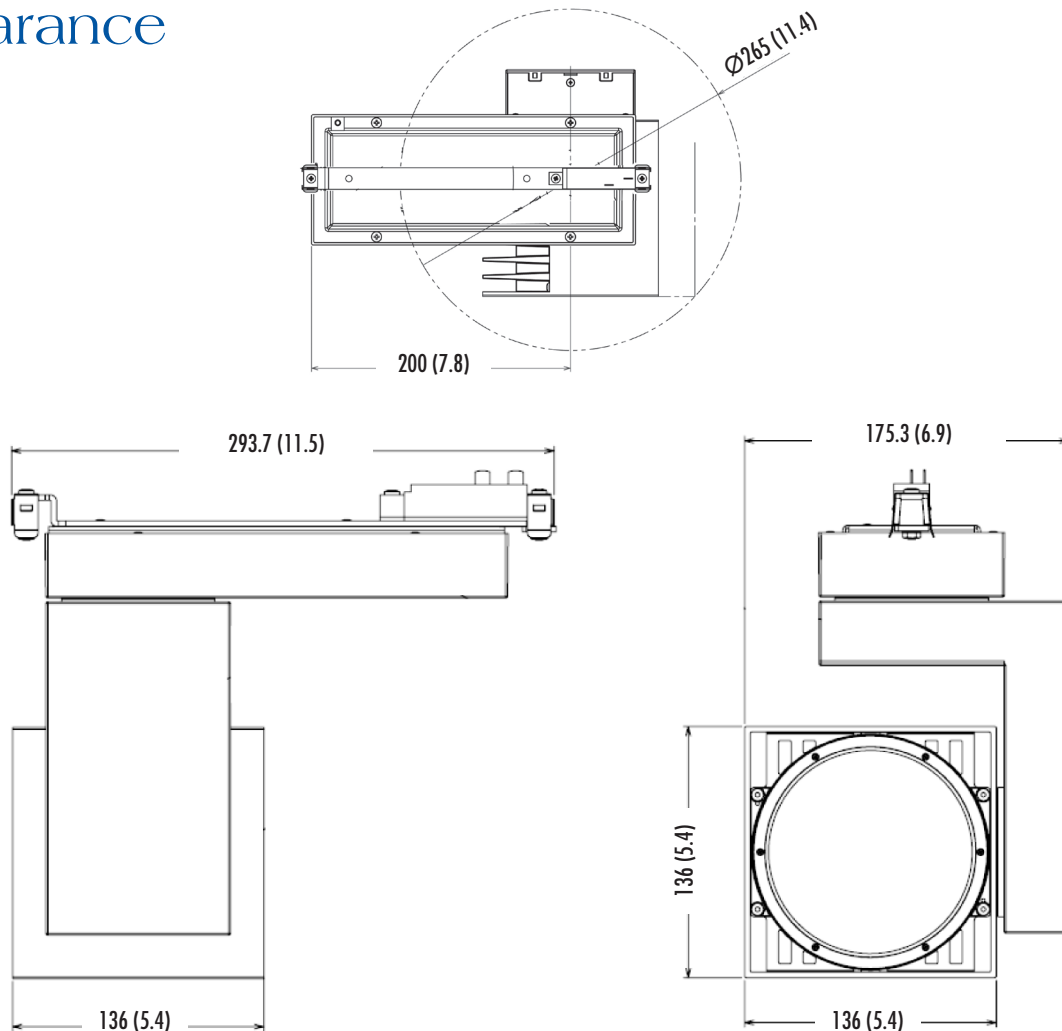

– see below for photometric reports –





SALIOT

Lighting Innovation MS-V5A smart motorized track mounted LED accent light



PHOTOMETRIC REPORT (14° Beam Angle) (tested per IESNA LM-79-2008)

UL Verification Services Report No. 12220506.01

Luminaire mesh network enabled LED track luminaire

LED 83 CRI modules, 2700K

LED Life rated 40,000 hours based on L70/B50 criteria. LM80 report by LED manufacturer furnished upon request

CANDLEPOWER DISTRIBUTION (Candela)

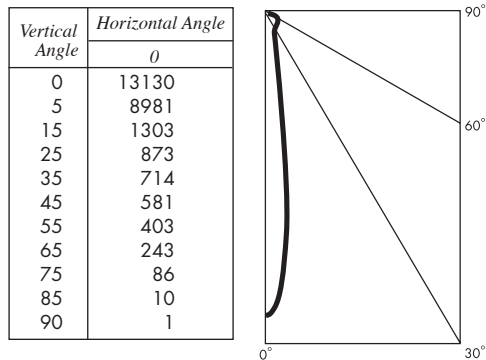

LUMINAIRE LIGHT OUTPUT AND EFFICACY

LED Module Type	Luminaire Light Output	Luminaire CBCP	Luminaire Efficacy (lumens/watt)	System Wattage
83CRI/2700K	3160	13130	52	78
83CRI/3000K	3223*	13393*	53*	78
83CRI/3500K	3318*	13787*	54*	78
83CRI/4000K	3413*	14180*	56*	78
83CRI/5000K	3558	14535	59	78

*estimated values

LIGHT OUTPUT MULTIPLIERS (based on 2700K)

LED Type	83CRI/2700K	83CRI/3000K	83CRI/3500K	83CRI/4000K	83CRI/5000K
Multiplier	1	1.02	1.05	1.08	1.13

PHOTOMETRIC REPORT (22° Beam Angle) (tested per IESNA LM-79-2008)

UL Verification Services Report No. 12220506.02

Luminaire mesh network enabled LED track luminaire

LED 83 CRI modules, 2700K

LED Life rated 40,000 hours based on L70/B50 criteria. LM80 report by LED manufacturer furnished upon request

CANDLEPOWER DISTRIBUTION (Candela)

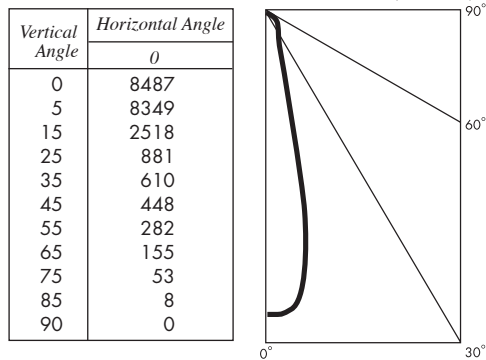

LUMINAIRE LIGHT OUTPUT AND EFFICACY

LED Module Type	Luminaire Light Output	Luminaire CBCP	Luminaire Efficacy (lumens/watt)	System Wattage
83CRI/2700K	3104	8487	51	78
83CRI/3000K	3166*	8657*	52*	78
83CRI/3500K	3259*	8911*	53*	78
83CRI/4000K	3352*	9166*	55*	78
83CRI/5000K	3621	9454	60	78

*estimated values

LIGHT OUTPUT MULTIPLIERS (based on 2700K)

LED Type	83CRI/2700K	83CRI/3000K	83CRI/3500K	83CRI/4000K	83CRI/5000K
Multiplier	1	1.02	1.05	1.08	1.13

PHOTOMETRIC REPORT (36° Beam Angle) (tested per IESNA LM-79-2008)

UL Verification Services Report No. 12220506.03

Luminaire mesh network enabled LED track luminaire

LED 83 CRI modules, 2700K

LED Life rated 40,000 hours based on L70/B50 criteria. LM80 report by LED manufacturer furnished upon request

CANDLEPOWER DISTRIBUTION (Candela)

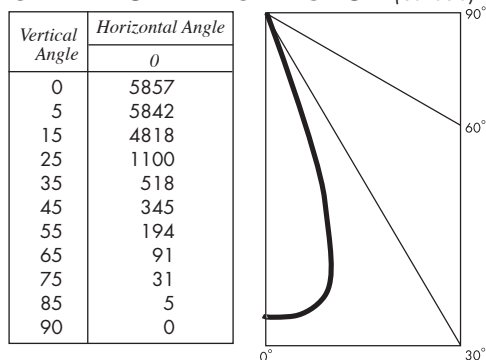

LUMINAIRE LIGHT OUTPUT AND EFFICACY

LED Module Type	Luminaire Light Output	Luminaire CBCP	Luminaire Efficacy (lumens/watt)	System Wattage
83CRI/2700K	3378	5857	55	78
83CRI/3000K	3446*	5974*	56*	78
83CRI/3500K	3547*	6150*	58*	78
83CRI/4000K	3648*	6326*	60*	78
83CRI/5000K	3824	6581	63	78

*estimated values

LIGHT OUTPUT MULTIPLIERS (based on 2700K)

LED Type	83CRI/2700K	83CRI/3000K	83CRI/3500K	83CRI/4000K	83CRI/5000K
Multiplier	1	1.02	1.05	1.08	1.13